







The Courthouse, Horseferry Road, Westminster, London, SW1P .| £1,150

- 3 Bedrooms : 2 Bathrooms : Reception Room : Kitchen
- Communal Courtyard
- 24 Hour Concierge : Gym :
- 2 Balconies : Lift :

- Available 02 August 2019

"Vita Properties have been tremendously helpful throughout the process of securing/renting my flat. Informative about the property, prompt communication, easy to use dashboard for sharing of information, and pleasant to work with. Highly recommend!"

Located within this beautiful modern development is this 3 bedroom 2 bathroom luxury apartment with two balconies is located on the on the 3rd floor (with lift) of a recently built Courthouse development in the heart Westminster. The accommodation comprises a substantial open plan reception room with a smart fitted kitchen with Miele appliances, access to a private terrace. Master bedroom with en suite shower room, walk in wardrobe area and another balcony. Two further double bedrooms. Family bathroom. The Courthouse benefits from an excellent gymnasium, communal courtyard, 24 hour concierge and lift access to all floors. It is located on the corner of Horseferry Road and Marsham Street, and occupies the former site of the City of Westminster Magistrates' Court. Luxurious lobby creates a welcoming space. Nearby transport links include Pimlico Underground Station (Victoria line) 0.5 miles, St James's Park Underground Station (Circle and District lines) 0.5 miles and Westminster Underground Station (Circle, District and Jubilee lines) 0.

- 

Flat
Let STC
x 3
x 1
x 3



Oliver Kent

 oliver.kent@vitaproperties.uk
 +4477 7274 0351



"I was very impressed with Vita and their network of buyers. When the sale of my flat fell through (twice) they worked extremely hard to find new buyers in a difficult market - thank you!"



"Working with Vita properties has been a smooth experience! No complaints at all. Our letting agent, Diana has been fantastic and very helpful throughout the whole process. I would highly recommend both Vita properties and Diana."



"I used Vita properties to find a flat recently and it was an overall professional, personalised and positive experience. Saira went the extra mile to accommodate to our needs and quick to help us whenever possible."



MORE INFO, PICTURES,
CONTACT ON
OUR WEBSITE



"Vita Properties is a very professional agency. My experience with them was incredible and the entire team was very helpful and kind throughout the renting process. I'd highly recommend!"

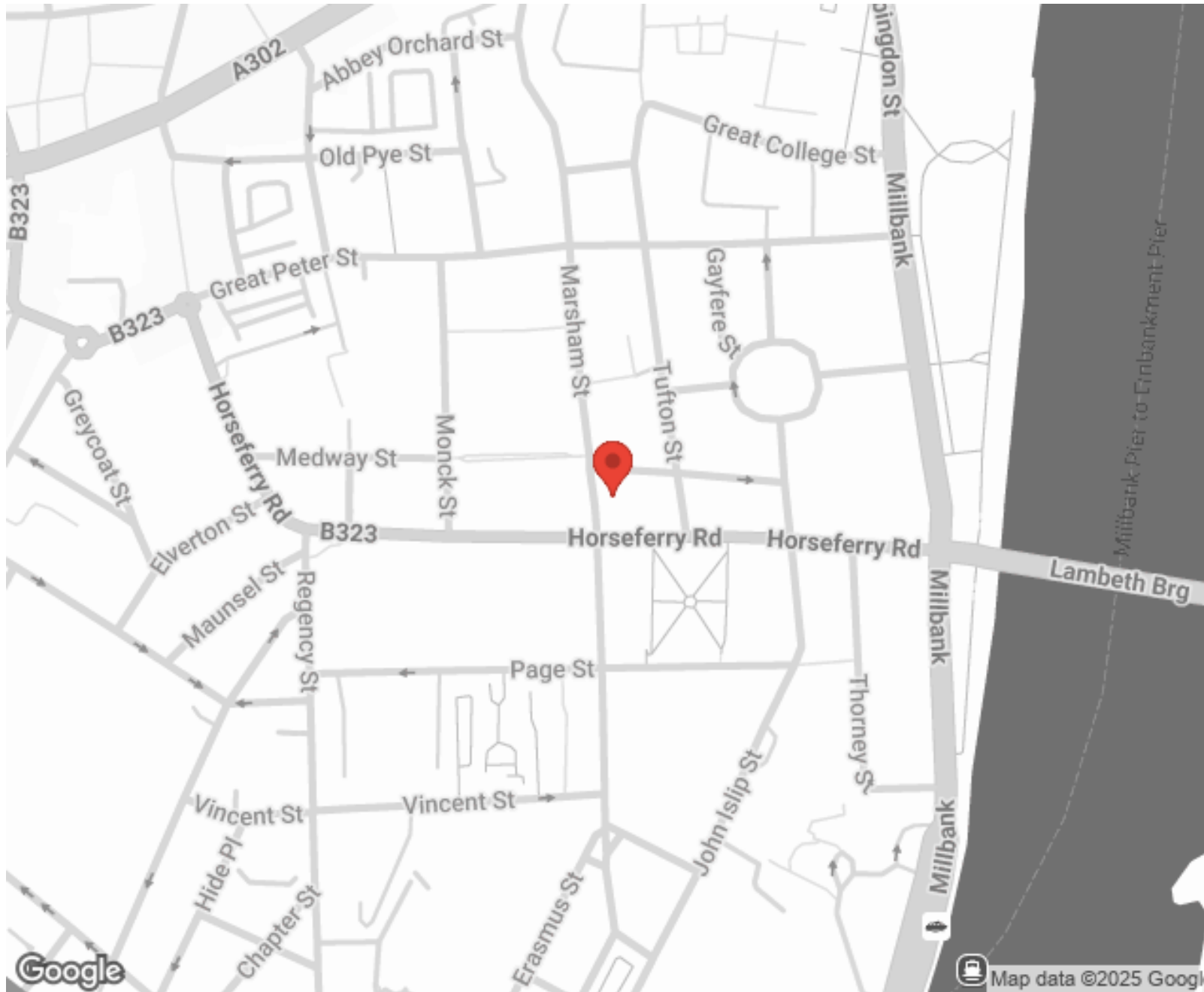

SCAN FOR MORE
GOOGLE REVIEWS



Google



4.9 Stars | 132 Reviews

Find us on social media



The Corthouse



Approximate Gross Internal Area = 1231 sq ft / 114.4 sq m

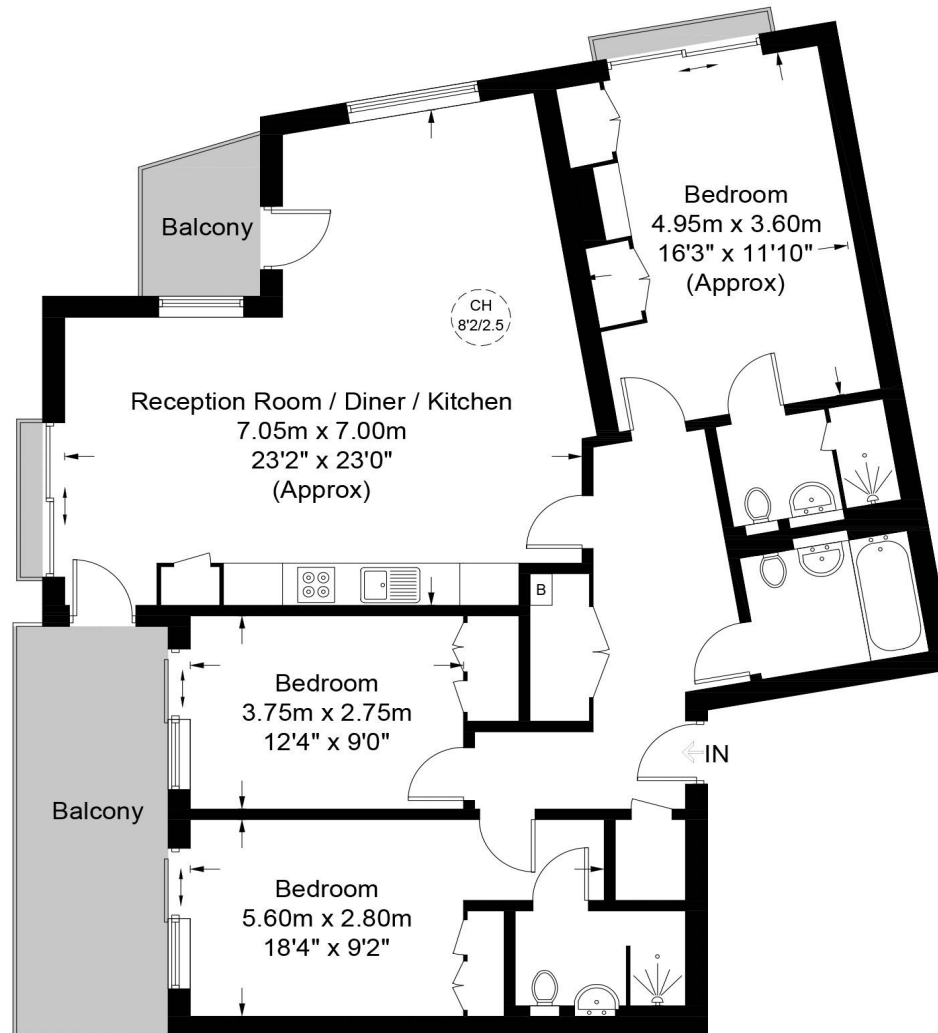

Third Floor

This plan is for layout guidance only. Not drawn to scale unless stated. Windows and door openings are approximate. Whilst every care is taken in the preparation of this plan, please check all dimensions, shapes and compass bearings before making any decisions reliant upon them. (ID559523)