



Eton Road, Belsize Park, London, NW3 .| £500

- Two Bed, Two Bath
- Raised Ground Floor
- High Ceilings
- Great Location

- Available for Immediate Occupation

"Vita Properties have been tremendously helpful throughout the process of securing/renting my flat. Informative about the property, prompt communication, easy to use dashboard for sharing of information, and pleasant to work with. Highly recommend!"

A lovely two bed apartment bursting with timeless original features such as high ceilings throughout, feature fireplace in the living room and a pleasing combination of large bay windows and sash windows.

Comprising of a large semi-open plan living room and kitchen, master bedroom with en-suite shower room, second bedroom and large family bathroom.

Set on the raised ground floor this apartment is set a 5 minute walk from Chalk Farm Underground (Northern Line) and the many amenities of Haverstock Hill.



Oliver Kent

✉ [oliver.kent@vitaproperties.uk](mailto:oliver.kent@vitaproperties.uk)

☎ +4477 7274 0351



🏠	Flat
🔑	Under Negotiation
🛏	x 2
🛋	x 1
🚿	x 2



"I was very impressed with Vita and their network of buyers. When the sale of my flat fell through (twice) they worked extremely hard to find new buyers in a difficult market - thank you!"

---



"Working with Vita properties has been a smooth experience! No complaints at all. Our letting agent, Diana has been fantastic and very helpful throughout the whole process. I would highly recommend both Vita properties and Diana."

---



"I used Vita properties to find a flat recently and it was an overall professional, personalised and positive experience. Saira went the extra mile to accommodate to our needs and quick to help us whenever possible."

---



**MORE INFO, PICTURES,  
CONTACT ON  
OUR WEBSITE**



"Vita Properties is a very professional agency. My experience with them was incredible and the entire team was very helpful and kind throughout the renting process. I'd highly recommend!"

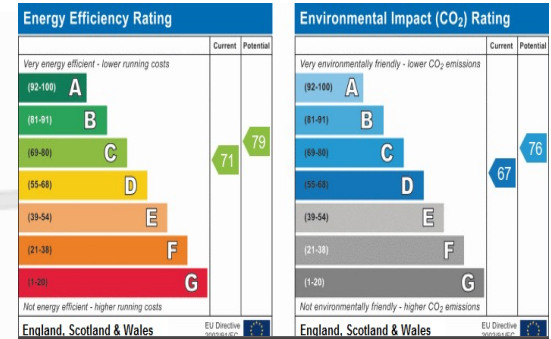
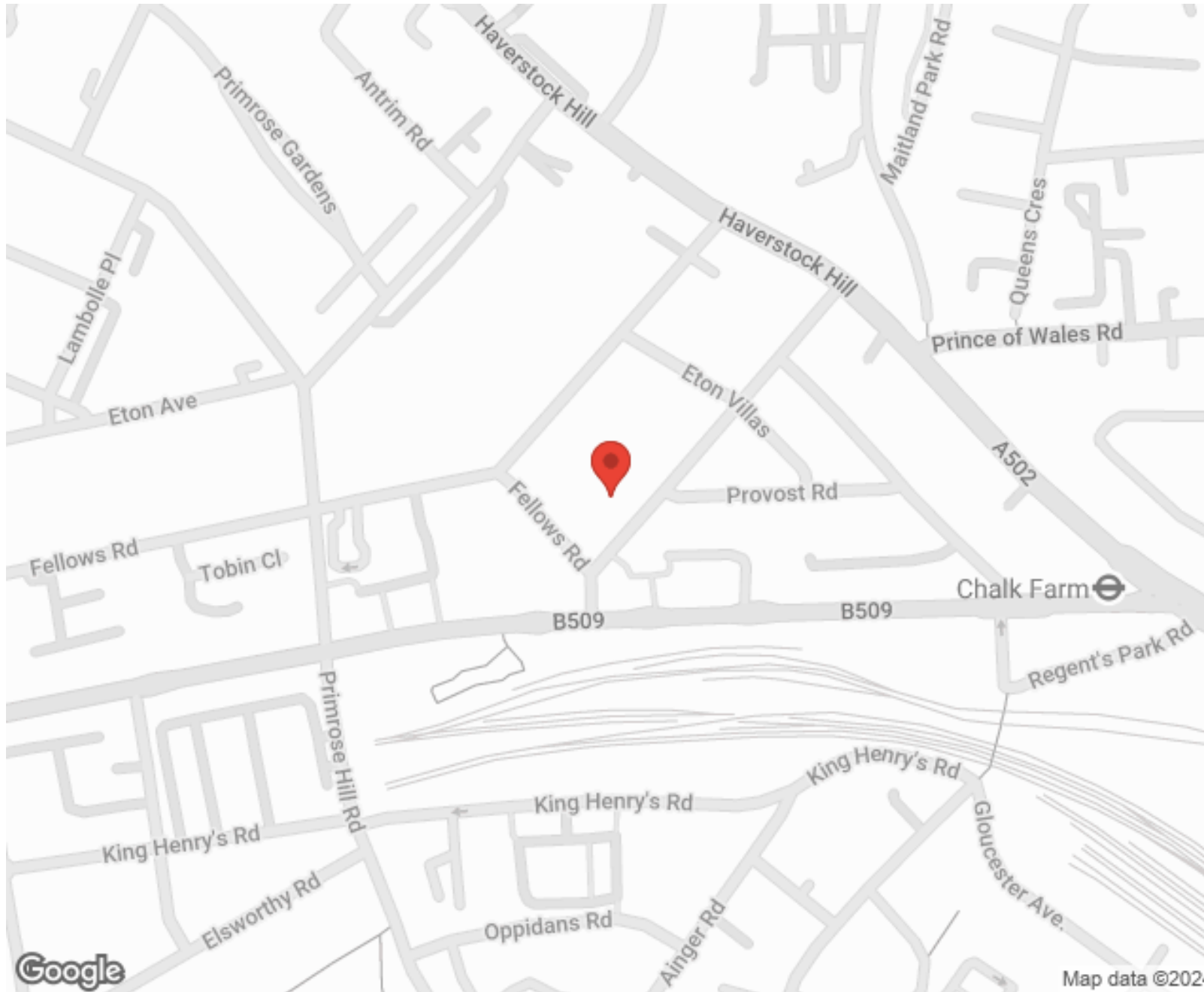

SCAN FOR MORE  
GOOGLE REVIEWS



Google



4.9 Stars | 132 Reviews

Find us on social media

- vitaproperties
- VitaProperties
- VitaProperties

# Eton Road

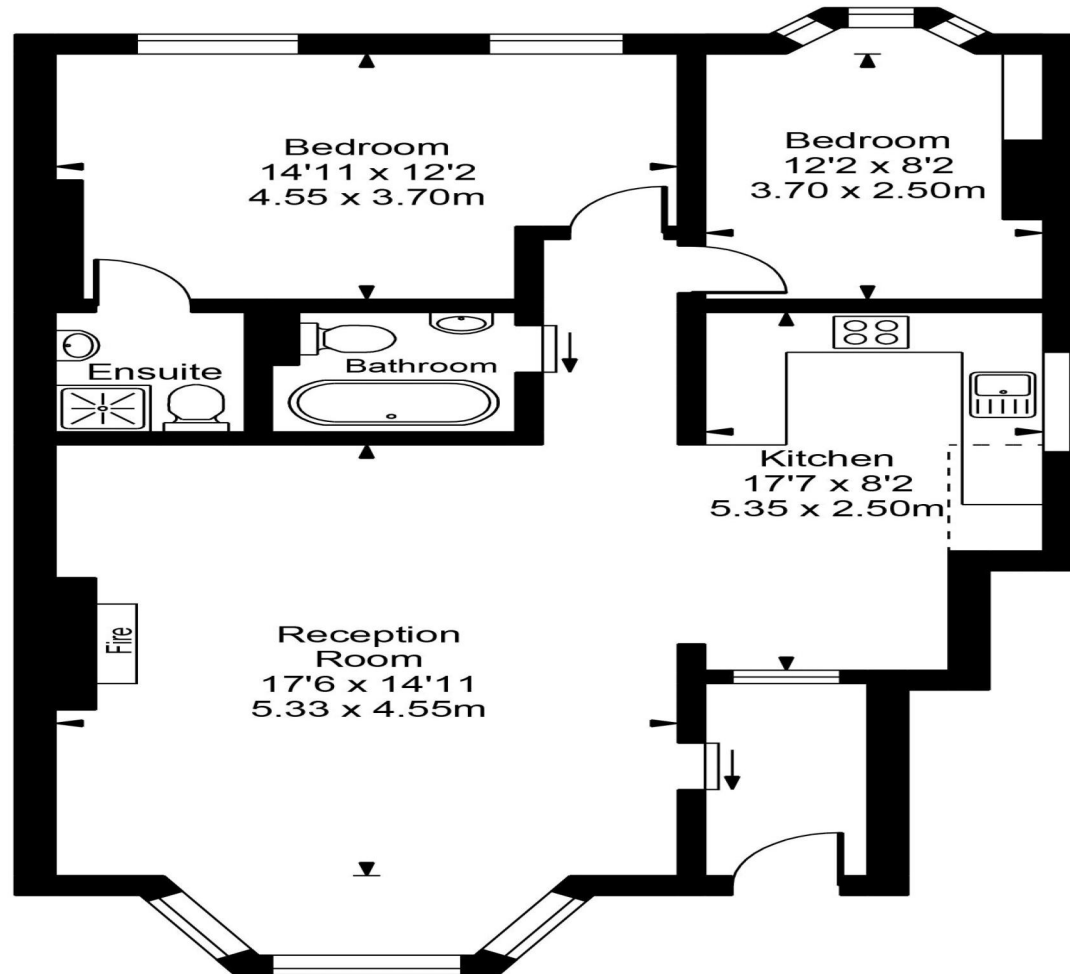
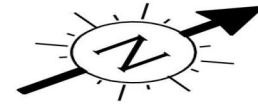

**Approx Gross Internal Area 951 Sq Ft - 88.35 Sq M**

FOR ILLUSTRATIVE PURPOSES ONLY. NOT TO SCALE.

Whilst every attempt has been made to ensure the accuracy of the floorplan shown, all measurements, positioning, fixtures, fittings and any other data shown are an approximate interpretation for illustrative purposes only and are not to scale. No responsibility is taken for any error, omission, misstatement or use of data shown. Floor plan by [www.bestangle.co.uk](http://www.bestangle.co.uk)