



## Downe Mansions, Gondar Gardens, West Hampstead, London NW6 .| £550

- Second Floor
- Solid Hardwood Floors to Communals
- Three Bedrooms
- Fully Integrated Kitchen

- High Ceilings
- Available 4th March

"Vita Properties have been tremendously helpful throughout the process of securing/renting my flat. Informative about the property, prompt communication, easy to use dashboard for sharing of information, and pleasant to work with. Highly recommend!"

Set on the second floor of this purpose built Victorian mansion block is this large three bed property which beautifully incorporates the stunning features you come to expect of these period conversions - high ceilings, large windows & multiple feature fireplaces. As well as some more modern fittings including solid wood floors, spot lighting, large built in wardrobes with pressure doors, a fully integrated kitchen/diner with added bonus of television above the stove. All three bedrooms are good sized doubles, with the master being slightly bigger.

Residents will also benefit from well manicured communal gardens

Set on a picturesque residential street and within a 15 minute walking distance of 5 stations; West Hampstead (Overground), West Hampstead (Jubilee), Kilburn (Jubilee) & Cricklewood (Overground)



Oliver Kent

✉ [oliver.kent@vitaproperties.uk](mailto:oliver.kent@vitaproperties.uk)  
☎ +4477 7274 0351



🏠	Flat
🔑	Under Negotiation
🛏️	x 3
🛋️	x 1
🚿	x 1

"I was very impressed with Vita and their network of buyers. When the sale of my flat fell through (twice) they worked extremely hard to find new buyers in a difficult market - thank you!"

---



"Working with Vita properties has been a smooth experience! No complaints at all. Our letting agent, Diana has been fantastic and very helpful throughout the whole process. I would highly recommend both Vita properties and Diana."

---



"I used Vita properties to find a flat recently and it was an overall professional, personalised and positive experience. Saira went the extra mile to accommodate to our needs and quick to help us whenever possible."

---



**MORE INFO, PICTURES,  
CONTACT ON  
OUR WEBSITE**





# Downe Mansions

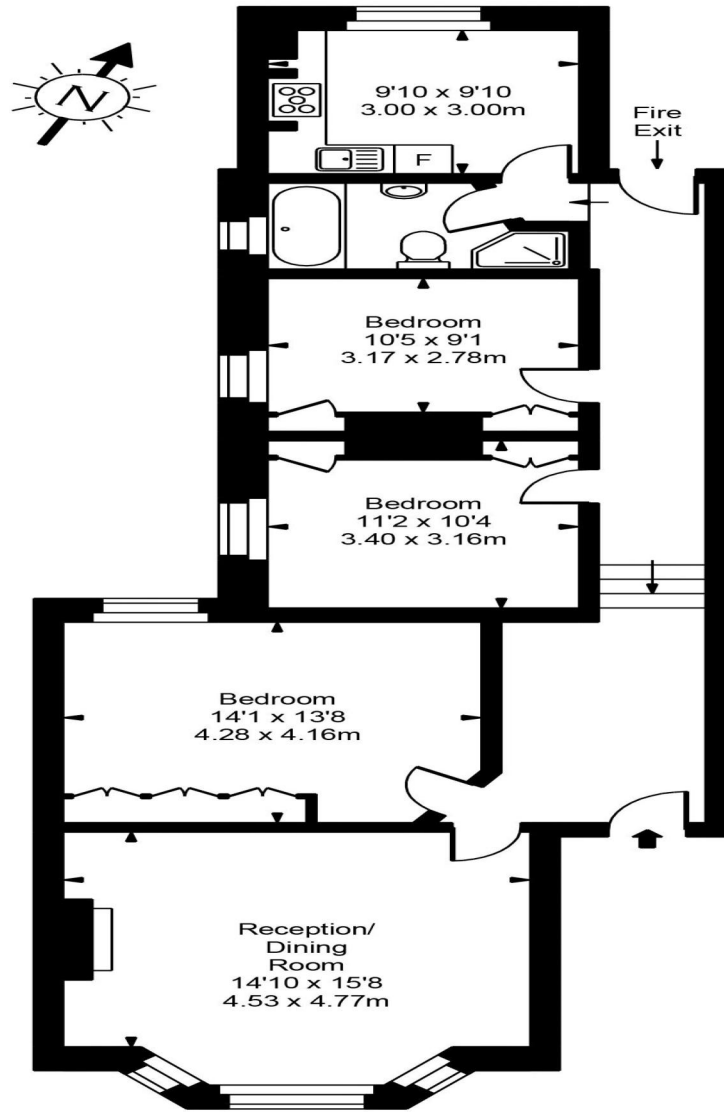

Second Floor

Approx Gross Internal Area **1124 Sq Ft - 104.42 Sq M**

FOR ILLUSTRATIVE PURPOSES ONLY. NOT TO SCALE.

Whilst every attempt has been made to ensure the accuracy of the floorplan shown, all measurements, positioning, fixtures, fittings and any other data shown are an approximate interpretation for illustrative purposes only and are not to scale. No responsibility is taken for any error, omission, miss-statement or use of data shown. Floor plan by [www.bestangle.co.uk](http://www.bestangle.co.uk)

