



Abercorn Place, St Johns Wood, London, NW8 .| £300

- Wooden floors
- Lift
- Porter
- Offered Unfurnished

- Moments to St Johns Wood and Maida Vale
- Available 31st Jan

"Vita Properties have been tremendously helpful throughout the process of securing/renting my flat. Informative about the property, prompt communication, easy to use dashboard for sharing of information, and pleasant to work with. Highly recommend!"

Available 31st Jan and set in this porterted block in St Johns Wood is this attractive studio apartment set on the first floor (Lift). Offering plenty of natural light, a separate fitted kitchen and a new bathroom. This flat also benefits from wooden floors, heating and hot water included with in rent. Abercorn Place is also moments from the beautiful Violet Hill Gardens all the amenities of Maida Vale and Little Venice.

Offered Unfurnished



Oliver Kent

✉ oliver.kent@vitaproperties.uk

☎ +4477 7274 0351



🏠	Flat
🔑	Available to Let
🛏️	x 0
🛋️	x 1
🚿	x 1



"I was very impressed with Vita and their network of buyers. When the sale of my flat fell through (twice) they worked extremely hard to find new buyers in a difficult market - thank you!"



"Working with Vita properties has been a smooth experience! No complaints at all. Our letting agent, Diana has been fantastic and very helpful throughout the whole process. I would highly recommend both Vita properties and Diana."



"I used Vita properties to find a flat recently and it was an overall professional, personalised and positive experience. Saira went the extra mile to accommodate to our needs and quick to help us whenever possible."



**MORE INFO, PICTURES,
CONTACT ON
OUR WEBSITE**



Abercorn Place

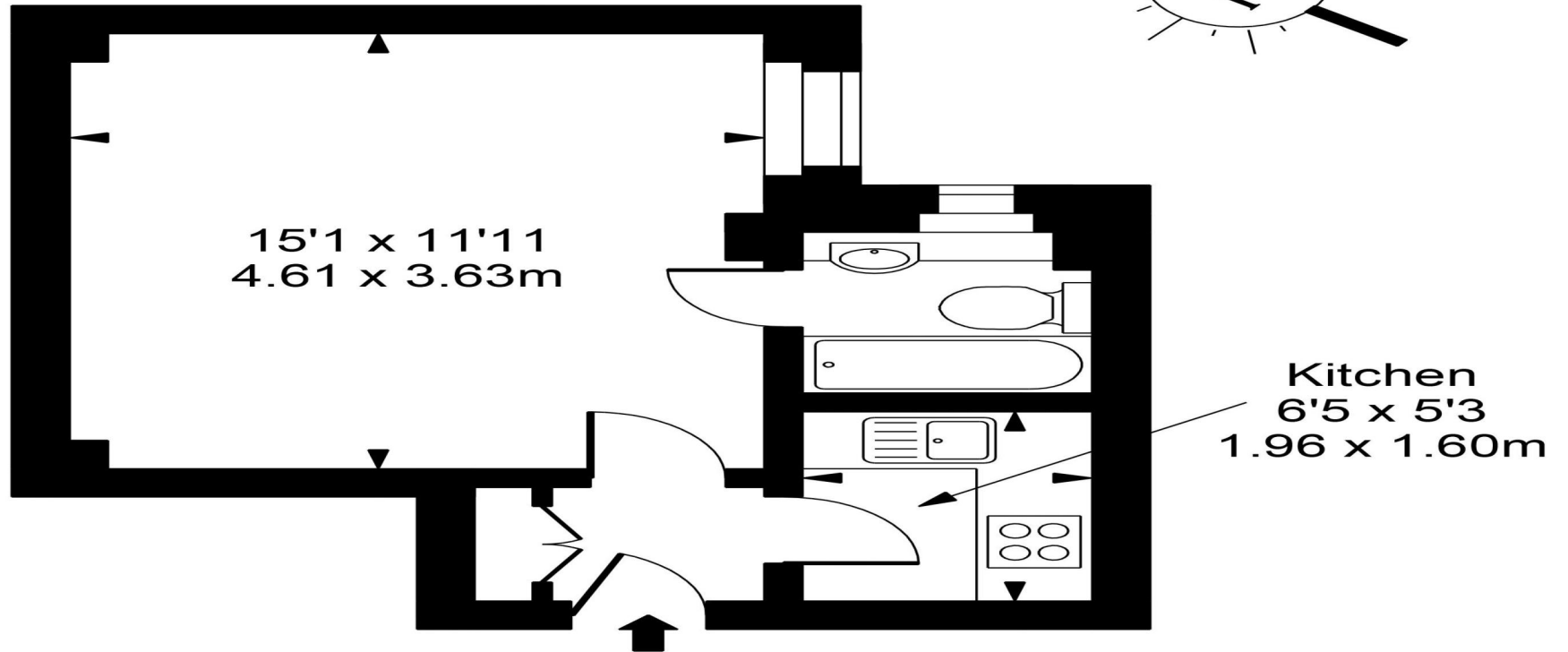
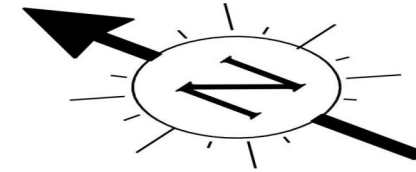

First Floor



Approx Gross Internal Area **272 Sq Ft - 25.27 Sq M**

FOR ILLUSTRATIVE PURPOSES ONLY. NOT TO SCALE.

Whilst every attempt has been made to ensure the accuracy of the floorplan shown, all measurements, positioning, fixtures, fittings and any other data shown are an approximate interpretation for illustrative purposes only and are not to scale. No responsibility is taken for any error, omission, miss-statement or use of data shown.
Floor plan by www.bestangle.co.uk