



Elgin Avenue, Maida Vale, London, W9 .| £550

- Newly refurbished
- High ceilings
- 850 sq. ft\*
- Two double bedrooms

- Close to Maida Vale Tube & Little Venice
- Available immediately

"Vita Properties have been tremendously helpful throughout the process of securing/renting my flat. Informative about the property, prompt communication, easy to use dashboard for sharing of information, and pleasant to work with. Highly recommend!"

Available immediately and finished to a beautiful standard is this immaculate apartment set on the raised ground floor of this converted Victorian building. Offered in brand new condition the property offers two double bedrooms and an en suite bathroom. Benefiting from extremely high ceilings throughout the property also boasts large sash windows and is offered on a furnished or unfurnished basis.

Set on Elgin Avenue the apartment is a short walk from Maida Vale Tube and Paddington Recreational Ground



Oliver Kent

✉ [oliver.kent@vitaproperties.uk](mailto:oliver.kent@vitaproperties.uk)  
☎ +4477 7274 0351



🏠	Flat
🔑	Available to Let
🛏️	x 2
🛋️	x 1
🚿	x 2



"I was very impressed with Vita and their network of buyers. When the sale of my flat fell through (twice) they worked extremely hard to find new buyers in a difficult market - thank you!"

---



"Working with Vita properties has been a smooth experience! No complaints at all. Our letting agent, Diana has been fantastic and very helpful throughout the whole process. I would highly recommend both Vita properties and Diana."

---



"I used Vita properties to find a flat recently and it was an overall professional, personalised and positive experience. Saira went the extra mile to accommodate to our needs and quick to help us whenever possible."

---



**MORE INFO, PICTURES,  
CONTACT ON  
OUR WEBSITE**



"Vita Properties is a very professional agency. My experience with them was incredible and the entire team was very helpful and kind throughout the renting process. I'd highly recommend!"

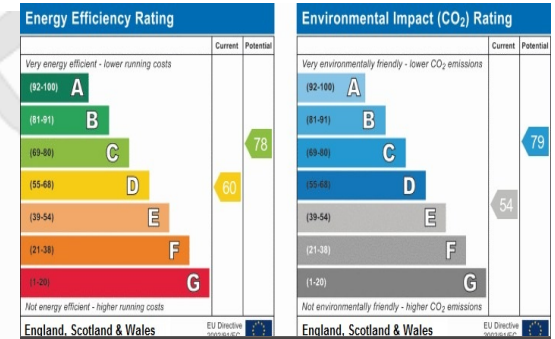
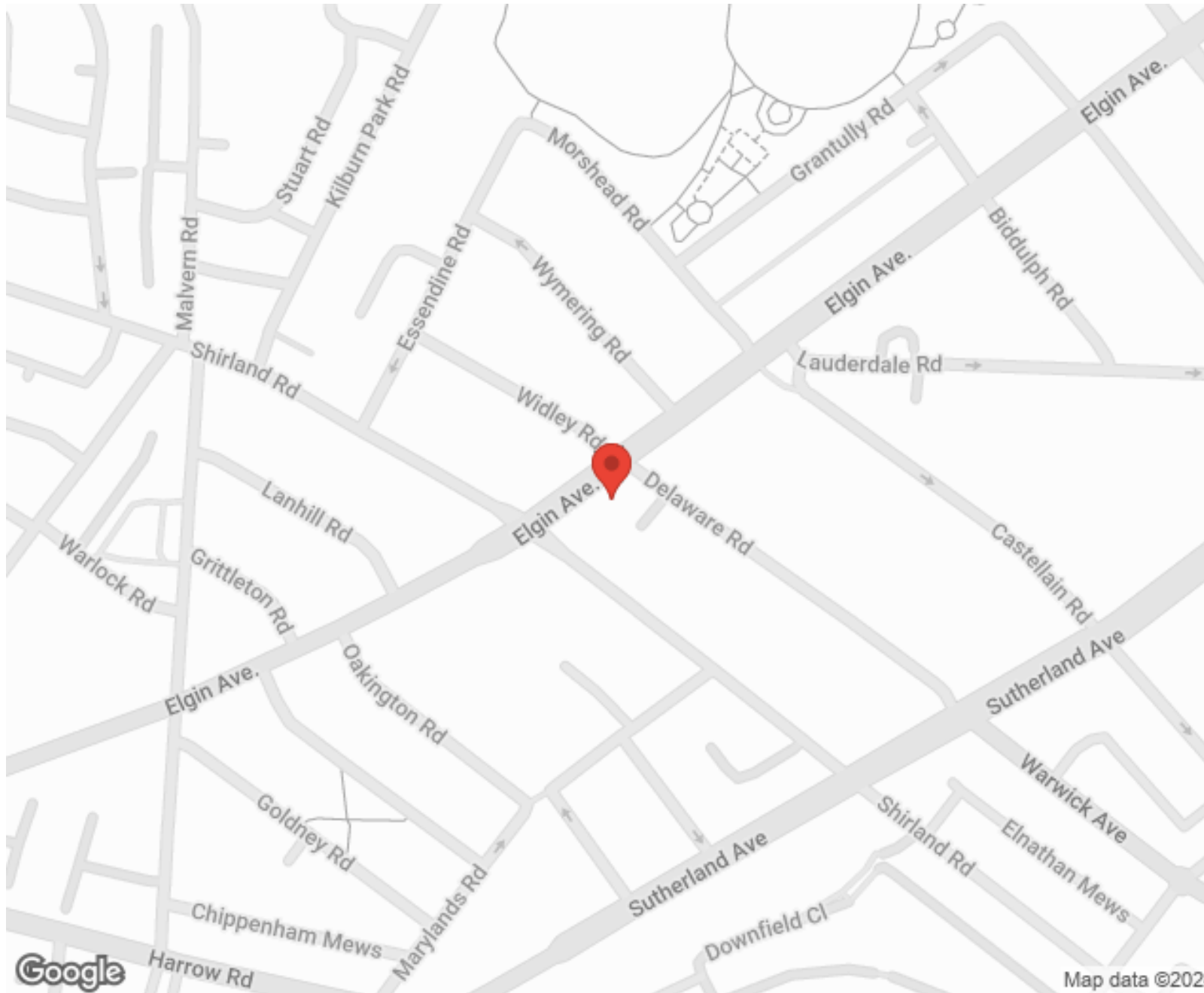

SCAN FOR MORE  
GOOGLE REVIEWS



Google



4.9 Stars | 132 Reviews

Find us on social media

- vitaproperties
- VitaProperties
- VitaProperties

**Elgin Avenue**

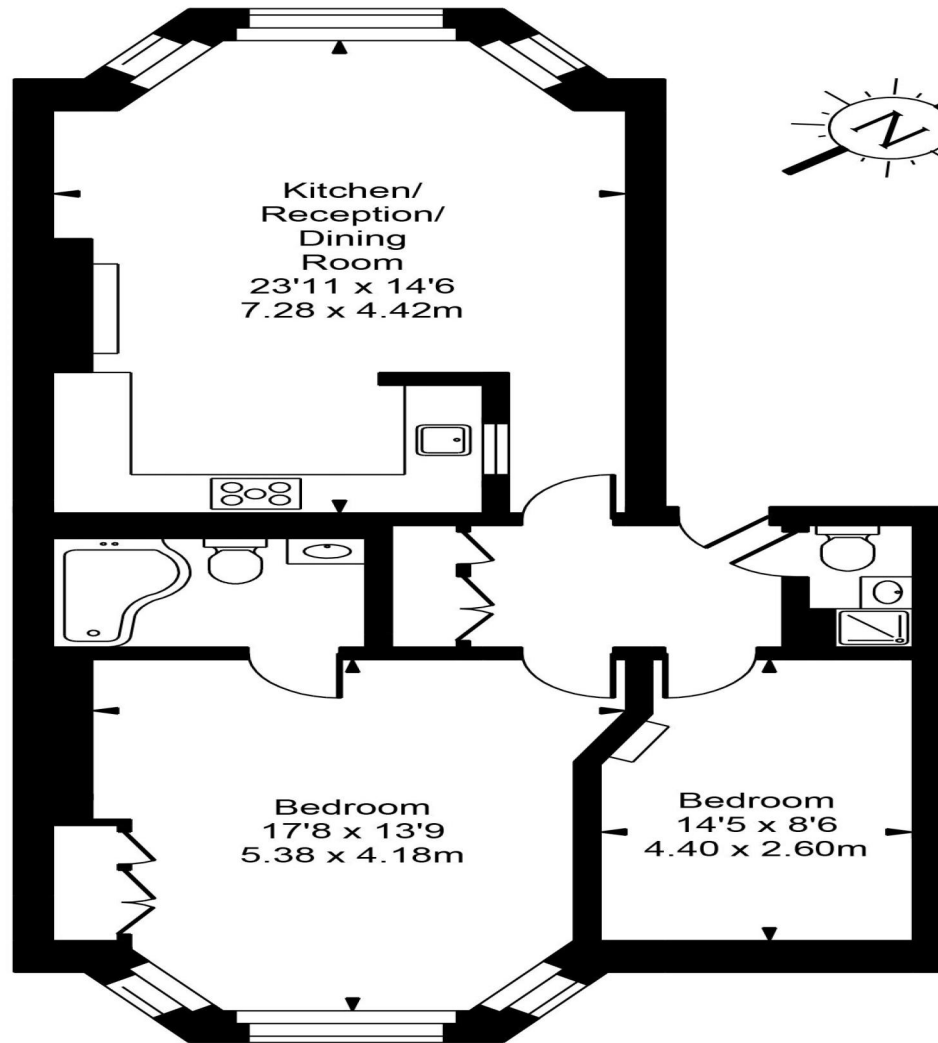

**Raised Ground Floor**

**Approx Gross Internal Area 834 Sq Ft - 77.48 Sq M**



FOR ILLUSTRATIVE PURPOSES ONLY. NOT TO SCALE.

Whilst every attempt has been made to ensure the accuracy of the floorplan shown, all measurements, positioning, fixtures, fittings and any other data shown are an approximate interpretation for illustrative purposes only and are not to scale. No responsibility is taken for any error, omission, miss-statement or use of data shown. Floor plan by [www.bestangle.co.uk](http://www.bestangle.co.uk)