



Fellows Road, Swiss Cottage, London, NW3 .| £280

- All Inclusive bills except for Council Tax
- Close to Belsize park and Swiss Cottage tube
- Available Immediately
- Managed

"Vita Properties have been tremendously helpful throughout the process of securing/renting my flat. Informative about the property, prompt communication, easy to use dashboard for sharing of information, and pleasant to work with. Highly recommend!"

We are delighted to offer a selection of self-contained studios situated in Belsize Park. Set within a beautiful conversion, the studios comprise open plan fitted kitchens and split level bedrooms. A short walk from Swiss Cottage tube station and the green space of Primrose Hill, these are a must see. Inclusive of all bills except for council tax. Offered furnished or unfurnished.

Available NOW



Oliver Kent

✉ oliver.kent@vitaproperties.uk

☎ +4477 7274 0351



🏠	Flat
🔑	Available to Let
🛏️	x 0
🪑	x 1
🚿	x 1



"I was very impressed with Vita and their network of buyers. When the sale of my flat fell through (twice) they worked extremely hard to find new buyers in a difficult market - thank you!"



"Working with Vita properties has been a smooth experience! No complaints at all. Our letting agent, Diana has been fantastic and very helpful throughout the whole process. I would highly recommend both Vita properties and Diana."



"I used Vita properties to find a flat recently and it was an overall professional, personalised and positive experience. Saira went the extra mile to accommodate to our needs and quick to help us whenever possible."



**MORE INFO, PICTURES,
CONTACT ON
OUR WEBSITE**



"Vita Properties is a very professional agency. My experience with them was incredible and the entire team was very helpful and kind throughout the renting process. I'd highly recommend!"

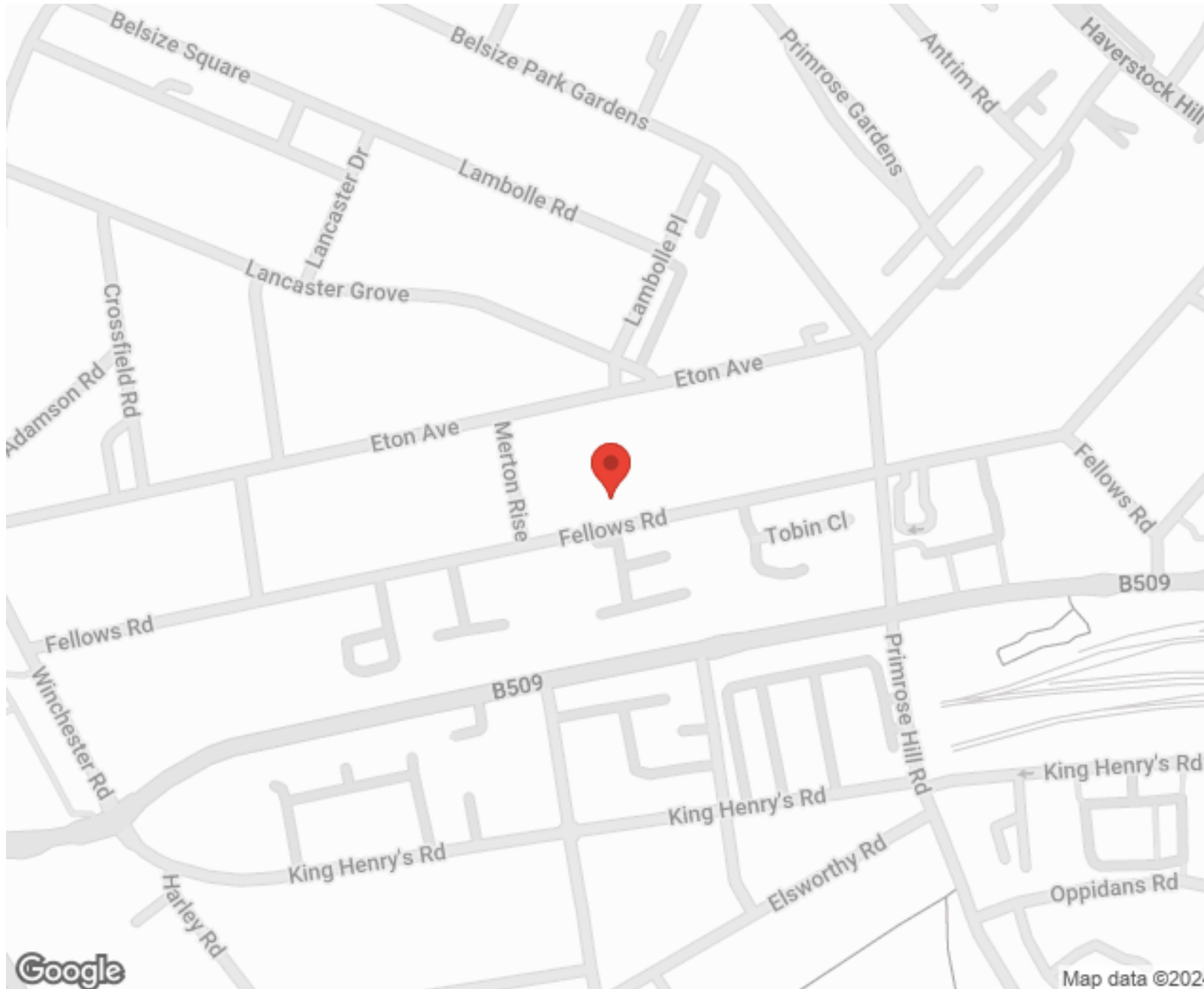

SCAN FOR MORE
GOOGLE REVIEWS



Google



4.9 Stars | 132 Reviews

Find us on social media

 vitaproperties

 VitaProperties

 VitaProperties

Fellows Road

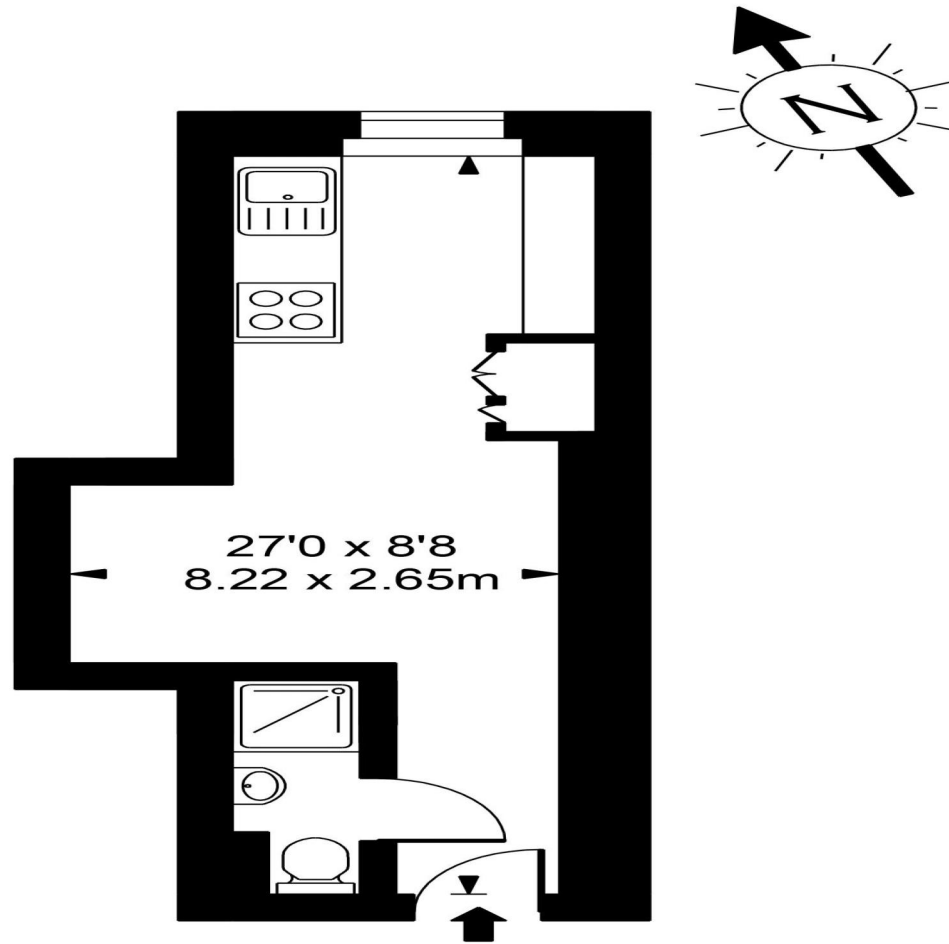

Ground Floor



Approx Gross Internal Area **198 Sq Ft - 18.40 Sq M**

For Illustration Purposes Only - Not To Scale
Floor plan by www.bestangle.co.uk