







Hallam Street, Marylebone, London, W1W .| £915

- Stones Throw from Great Portland Street Tube
- Newly Refurbished
- Wooden Floors
- Lift

- Spacious
- 2 Bathrooms
- Council tax - F - £984 per annum

"Vita Properties have been tremendously helpful throughout the process of securing/renting my flat. Informative about the property, prompt communication, easy to use dashboard for sharing of information, and pleasant to work with. Highly recommend!"

Available immediately and boasting a bright, fresh interior, this superb two bedroomed apartment benefits from being newly refurbished and being in an excellent location close to Great Portland Street and Regent's Park. Situated on the fourth floor of an excellent building just moments from Great Portland Street, this superb two bedroomed apartment boasts wonderful living space, a spacious reception room and a neutral decor throughout with a modern taste. In addition, the property comprises modern generous kitchen with granite surfaces two bathrooms, (1 en suite), lift and everyroom is situated off a beautiful entrance hall. Hallam Street is close to a comprehensive selection of shops, bars, cafes and restaurants, with Goodge Street, Tottenham Court Road and Oxford Street all close by. Transport links include, Great Portland Street a stones throw away (Metropolitan, Hammersmith & City and Circle lines) and Oxford Circus (Bakerloo, Central and Victoria lines) underground stations and a wealth of regular bus services.

-  Flat
-  Available to Let
-  x 2
-  x 1
-  x 2



Oliver Kent

 oliver.kent@vitaproperties.uk

 +4477 7274 0351



"I was very impressed with Vita and their network of buyers. When the sale of my flat fell through (twice) they worked extremely hard to find new buyers in a difficult market - thank you!"



"Working with Vita properties has been a smooth experience! No complaints at all. Our letting agent, Diana has been fantastic and very helpful throughout the whole process. I would highly recommend both Vita properties and Diana."



"I used Vita properties to find a flat recently and it was an overall professional, personalised and positive experience. Saira went the extra mile to accommodate to our needs and quick to help us whenever possible."



**MORE INFO, PICTURES,
CONTACT ON
OUR WEBSITE**



Rossetti House

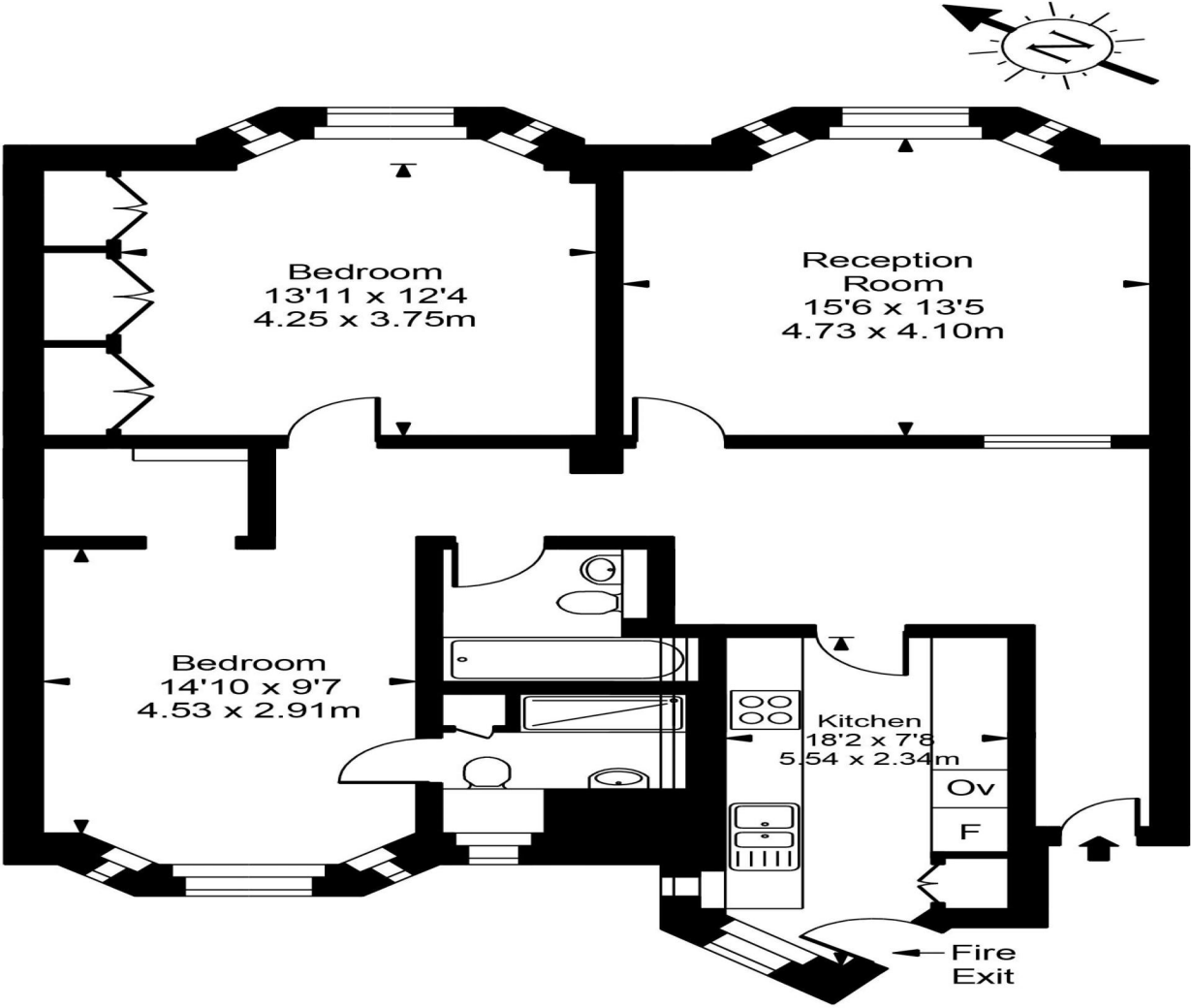

Second Floor



Approx Gross Internal Area **1041 Sq Ft - 96.69 Sq M**

For Illustration Purposes Only - Not To Scale
Floor plan by www.creativeplanetlk.com