



Hanover Gate Mansions, Park Road, Regents Park, London, NW1 .| £599,999

- Lift
- Moments to Regents Park and Baker Street
- Offered in good condition
- No upper chain

- 24hr Porter
- Leasehold

"Vita Properties have been tremendously helpful throughout the process of securing/renting my flat. Informative about the property, prompt communication, easy to use dashboard for sharing of information, and pleasant to work with. Highly recommend!"

Offered Chain free is this 4th floor (with lift) 1 bedroom apartment, set within a well regarded period building, location being only a 4 minute walk to the beautiful Regents Park and an 8 minute walk from Baker Street station and the many amenities of Baker Street. Benefiting from wooded floors and a fitted kitchen and offered in good condition throughout, the apartment has a spacious reception & dining room, open plan kitchen, a family bathroom, 24hr Porter and a sought after Regents Park location.

Leasehold



Oliver Kent

✉ oliver.kent@vitaproperties.uk

☎ +4477 7274 0351



"I was very impressed with Vita and their network of buyers. When the sale of my flat fell through (twice) they worked extremely hard to find new buyers in a difficult market - thank you!"



"Working with Vita properties has been a smooth experience! No complaints at all. Our letting agent, Diana has been fantastic and very helpful throughout the whole process. I would highly recommend both Vita properties and Diana."



"I used Vita properties to find a flat recently and it was an overall professional, personalised and positive experience. Saira went the extra mile to accommodate to our needs and quick to help us whenever possible."



**MORE INFO, PICTURES,
CONTACT ON
OUR WEBSITE**



"Vita Properties is a very professional agency. My experience with them was incredible and the entire team was very helpful and kind throughout the renting process. I'd highly recommend!"

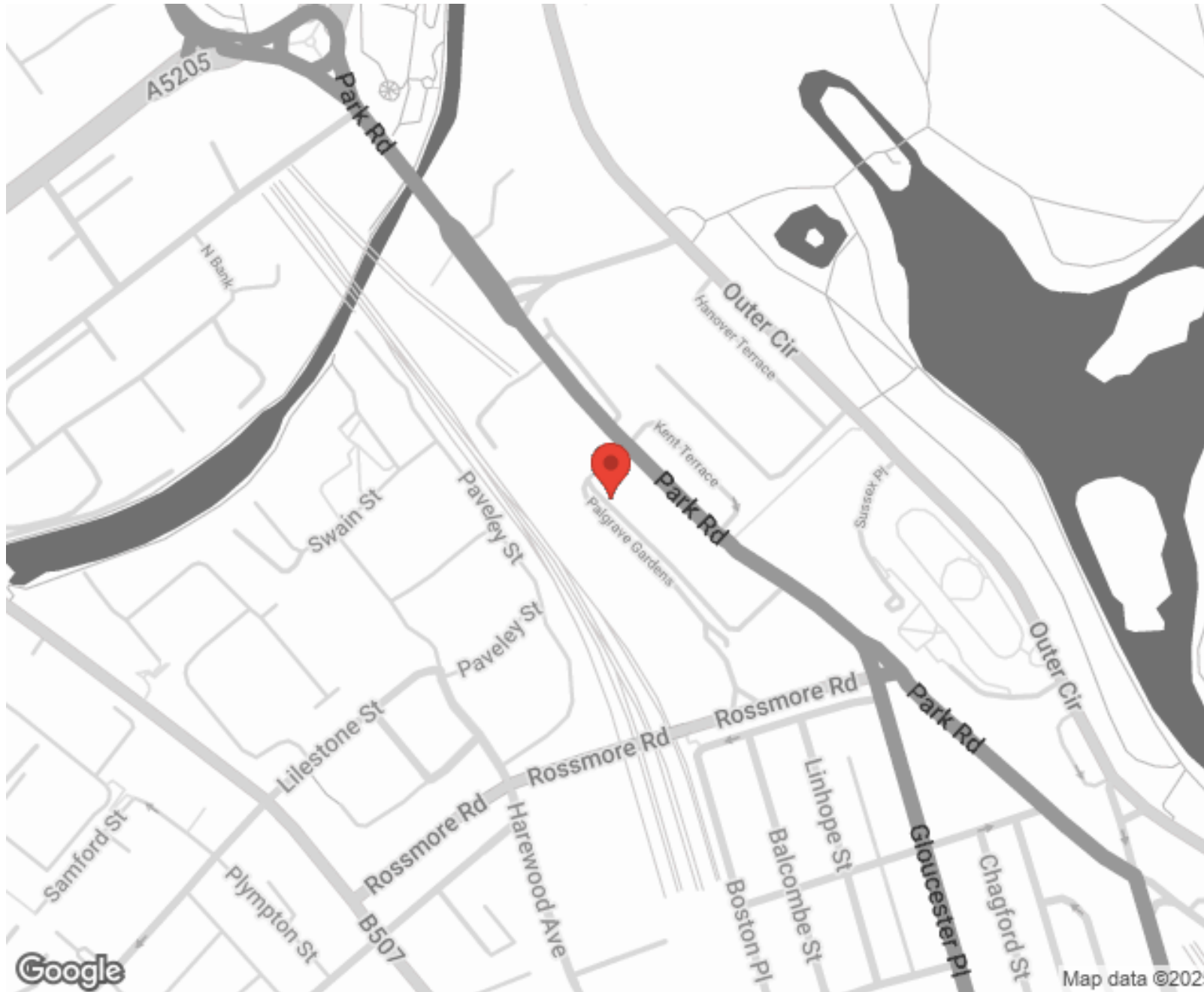

SCAN FOR MORE
GOOGLE REVIEWS





Google



4.9 Stars | 132 Reviews

Find us on social media

-  vitaproperties
-  VitaProperties
-  VitaProperties

Hanover Gate Mansions

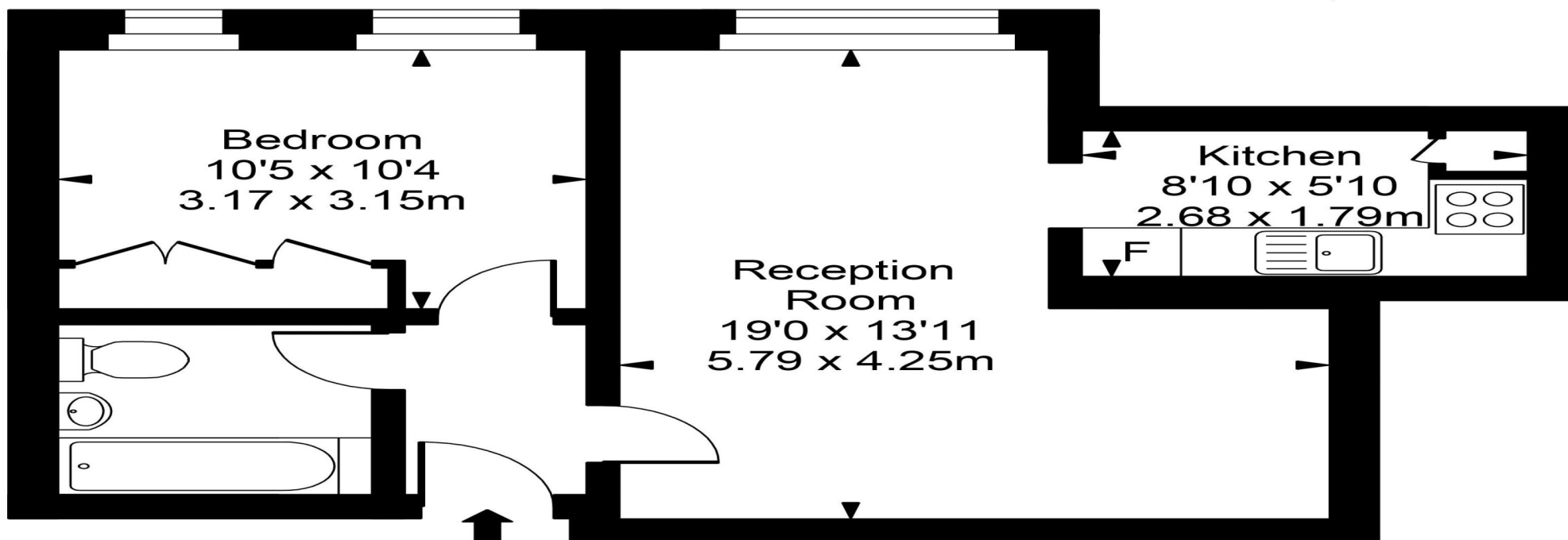
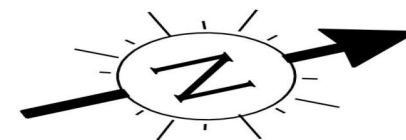

Top Floor



Approx Gross Internal Area

475 Sq Ft - 44.10 Sq M

For Illustration Purposes Only - Not To Scale
Floor plan by www.creativeplanetlk.com