



Woodfield Road, Notting Hill, London W9 .| £340

- Furnished or unfurnished, landlord is flexible
- Available immediately
- Situated between popular Maida Vale and Notting Hill
- offering great lateral space and light

- Mycounciltax.org.uk - C £609 per annum

"Vita Properties have been tremendously helpful throughout the process of securing/renting my flat. Informative about the property, prompt communication, easy to use dashboard for sharing of information, and pleasant to work with. Highly recommend!"

A wonderful newly refurbished one bedroom second floor apartment situated between popular Maida Vale and Notting Hill, ideally located for Warwick Avenue and Westbourne Grove tube stations. With views overlooking the Grand Union Canal. High ceilings this stunning apartment has modern features and gorgeous bay windows.

•SecondFloor•ReceptionRoom•Eat-in Kitchen •One large Bedroom • Bathroom •Brand New Development



Oliver Kent

✉ oliver.kent@vitaproperties.uk

☎ +4477 7274 0351



| | |
|----|-------------------|
| 🏠 | Flat |
| 🔑 | Under Negotiation |
| 🛋️ | x 1 |
| 🛏️ | x 1 |
| 🚿 | x 1 |



"I was very impressed with Vita and their network of buyers. When the sale of my flat fell through (twice) they worked extremely hard to find new buyers in a difficult market - thank you!"



"Working with Vita properties has been a smooth experience! No complaints at all. Our letting agent, Diana has been fantastic and very helpful throughout the whole process. I would highly recommend both Vita properties and Diana."



"I used Vita properties to find a flat recently and it was an overall professional, personalised and positive experience. Saira went the extra mile to accommodate to our needs and quick to help us whenever possible."



**MORE INFO, PICTURES,
CONTACT ON
OUR WEBSITE**



"Vita Properties is a very professional agency. My experience with them was incredible and the entire team was very helpful and kind throughout the renting process. I'd highly recommend!"

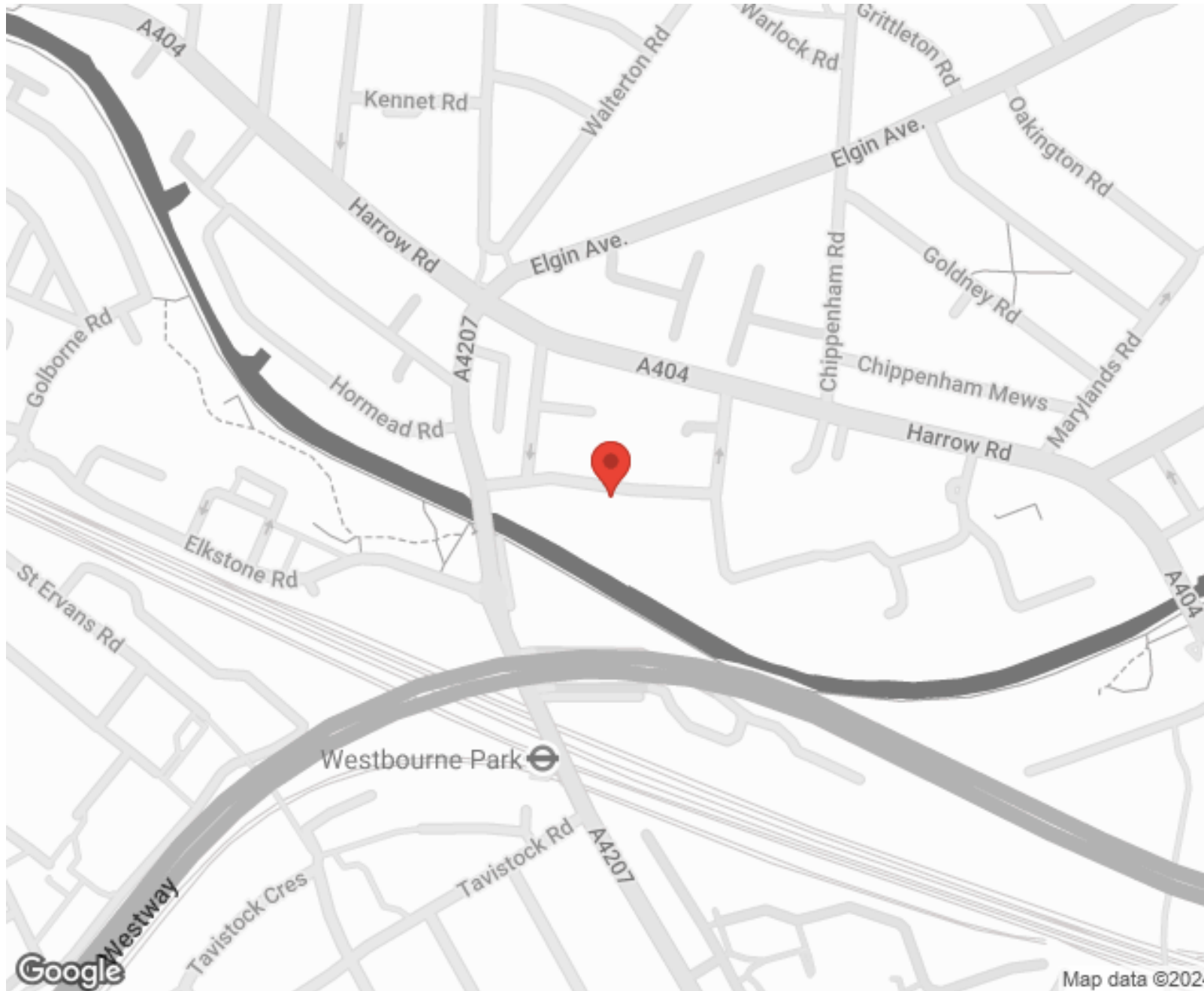

SCAN FOR MORE
GOOGLE REVIEWS



Google



4.9 Stars | 132 Reviews

Find us on social media

 vitaproperties

 VitaProperties

 VitaProperties

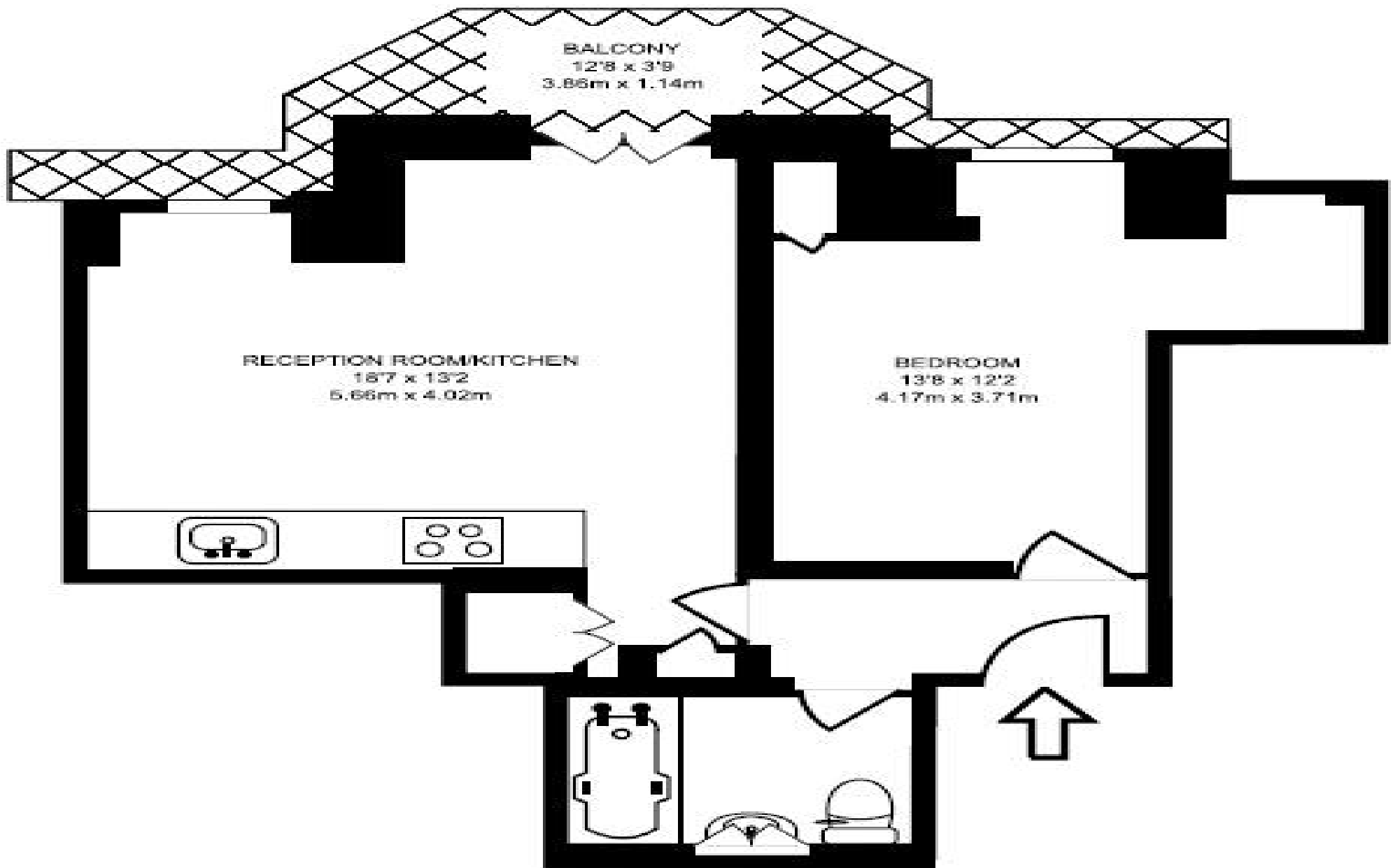

2nd Floor

442 SQ FT/41.05 SQ M

Representation of current layout, floor area approx 442 Sq Ft (41 Sq M)