



Park Street, Mayfair, London, W1K .| £795

- Larger than average
- Located in the heart of Mayfair
- Recently refurbished
- Moments from Hyde Park

- Available Mid April

"Vita Properties have been tremendously helpful throughout the process of securing/renting my flat. Informative about the property, prompt communication, easy to use dashboard for sharing of information, and pleasant to work with. Highly recommend!"

MOVE IN WITH NO TENANT FEE'S - A bright and spacious one bedroom apartment of situated on the fourth floor (LIFT) of this red brick period building with lift located close to Hyde Park, the shopping amenities of Oxford Street and transport links.. The apartment has been refurbished to a good standard with solid wood flooring throughout. Nearest Tube: Marble Arch / Bond Street. Mayfair is London`s most fashionable destination.

With London`s finest buildings, largest concentration of luxury hotels, best restaurants, bars, shopping, open spaces and hidden treasures all nestled together in a beautiful village setting



Oliver Kent

✉ oliver.kent@vitaproperties.uk
☎ +4477 7274 0351



🏠	Flat
🔑	Available to Let
🛏️	x 1
🛋️	x 1
🚿	x 1



"I was very impressed with Vita and their network of buyers. When the sale of my flat fell through (twice) they worked extremely hard to find new buyers in a difficult market - thank you!"



"Working with Vita properties has been a smooth experience! No complaints at all. Our letting agent, Diana has been fantastic and very helpful throughout the whole process. I would highly recommend both Vita properties and Diana."



"I used Vita properties to find a flat recently and it was an overall professional, personalised and positive experience. Saira went the extra mile to accommodate to our needs and quick to help us whenever possible."



**MORE INFO, PICTURES,
CONTACT ON
OUR WEBSITE**



"Vita Properties is a very professional agency. My experience with them was incredible and the entire team was very helpful and kind throughout the renting process. I'd highly recommend!"

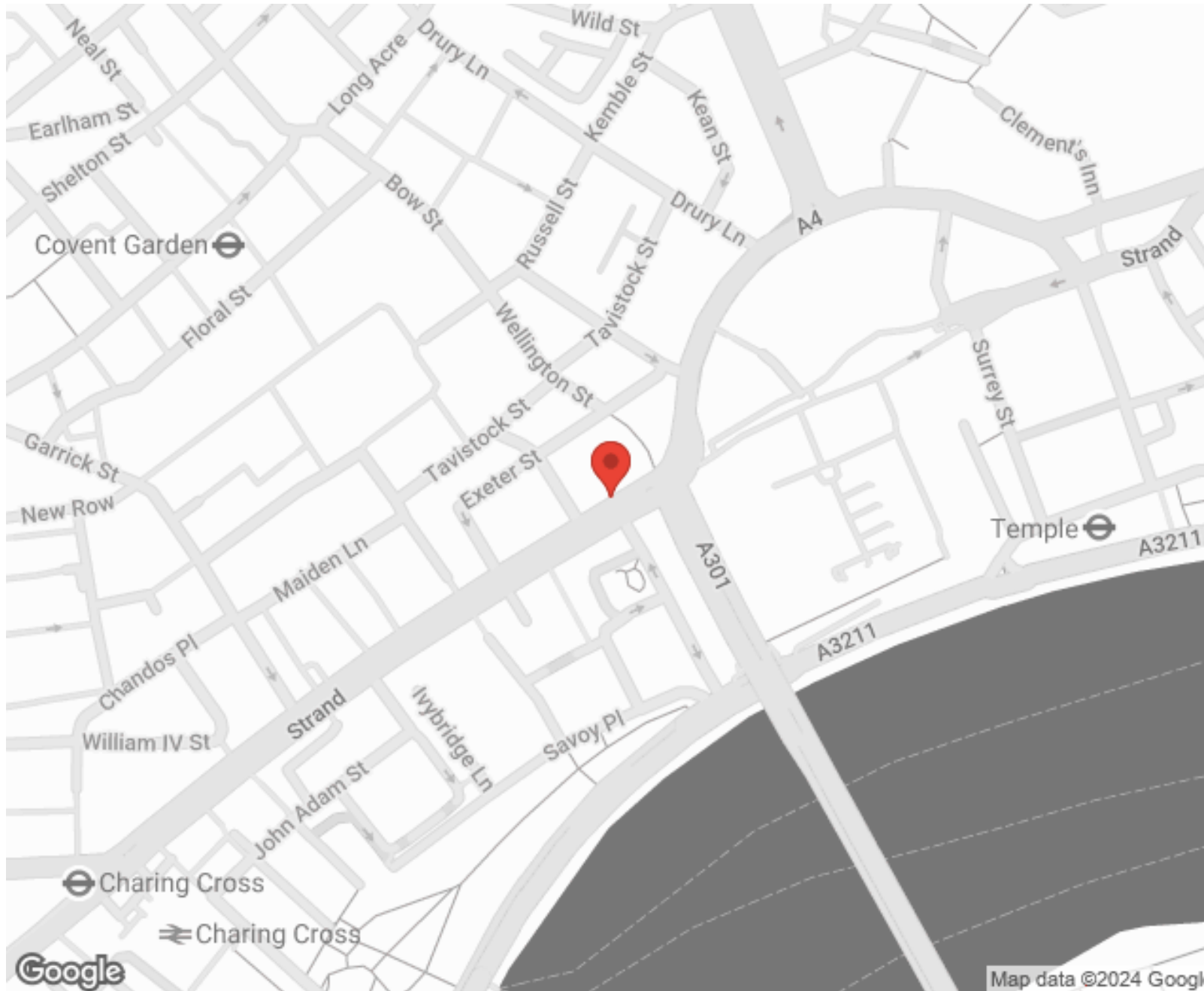

SCAN FOR MORE
GOOGLE REVIEWS





Google



4.9 Stars | 132 Reviews

Find us on social media

-  vitaproperties
-  VitaProperties
-  VitaProperties

Park Street

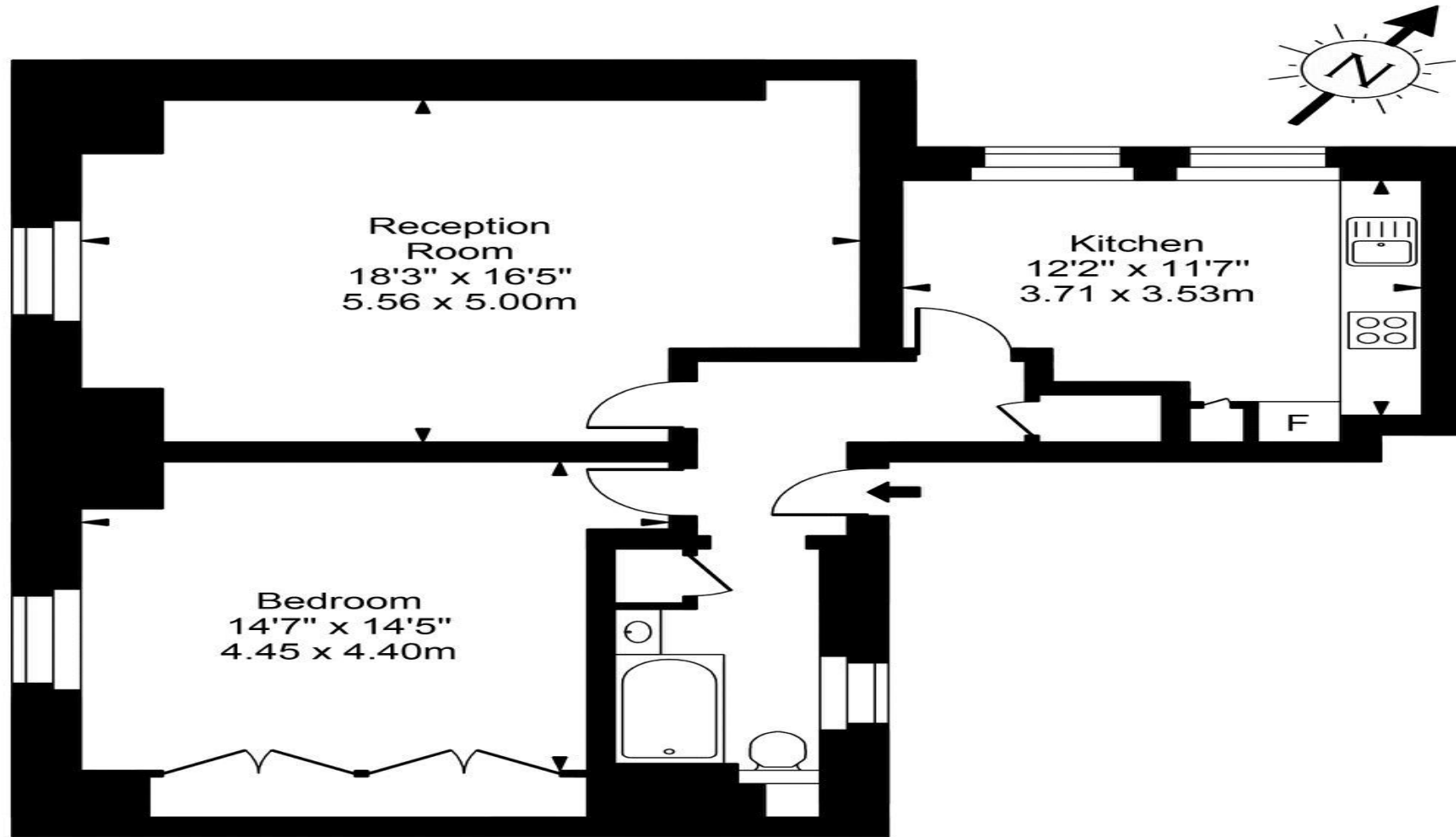

Fifth Floor



Approx Gross Internal Area 829 Sq Ft - 77.05 Sq M

For Illustration Purposes Only - Not To Scale
Floor plan by www.creativeplanetlk.com