



## Pulse Apartments 52 Lymington Road, London, NW6 .| £660

- Porter
- Parking
- Wooden Floors
- 2 Double Bedrooms

- Underfloor Heating
- Available immediately

"Vita Properties have been tremendously helpful throughout the process of securing/renting my flat. Informative about the property, prompt communication, easy to use dashboard for sharing of information, and pleasant to work with. Highly recommend!"

Available immediately is this rare opportunity to rent this state-of-the-art two bedroomed flat located on the third floor of a modern purpose built block. The property comprises stunning reception room, stylish open-plan kitchen with five burner stove and natural stone worktops, master bedroom with en suite bathroom, second bedroom and beautifully designed shower room. with guest cloakroom. Other benefits include a private balcony 24 hour portorage and underground secure parking. The Pulse is ideally located for access to the shops and excellent local amenities of Finchley Road and West Hampstead.

For travel links, the closest underground station is Finchley Road (Jubilee and Metropolitan lines) with British Rail services available via Finchley Road & Frognal Station



Oliver Kent

✉ [oliver.kent@vitaproperties.uk](mailto:oliver.kent@vitaproperties.uk)  
☎ +4477 7274 0351



🏠	Flat
🔑	Available to Let
🛏️	x 2
🛋️	x 1
🚶	x 2

"I was very impressed with Vita and their network of buyers. When the sale of my flat fell through (twice) they worked extremely hard to find new buyers in a difficult market - thank you!"

---



"Working with Vita properties has been a smooth experience! No complaints at all. Our letting agent, Diana has been fantastic and very helpful throughout the whole process. I would highly recommend both Vita properties and Diana."

---



"I used Vita properties to find a flat recently and it was an overall professional, personalised and positive experience. Saira went the extra mile to accommodate to our needs and quick to help us whenever possible."

---



**MORE INFO, PICTURES,  
CONTACT ON  
OUR WEBSITE**



"Vita Properties is a very professional agency. My experience with them was incredible and the entire team was very helpful and kind throughout the renting process. I'd highly recommend!"

---

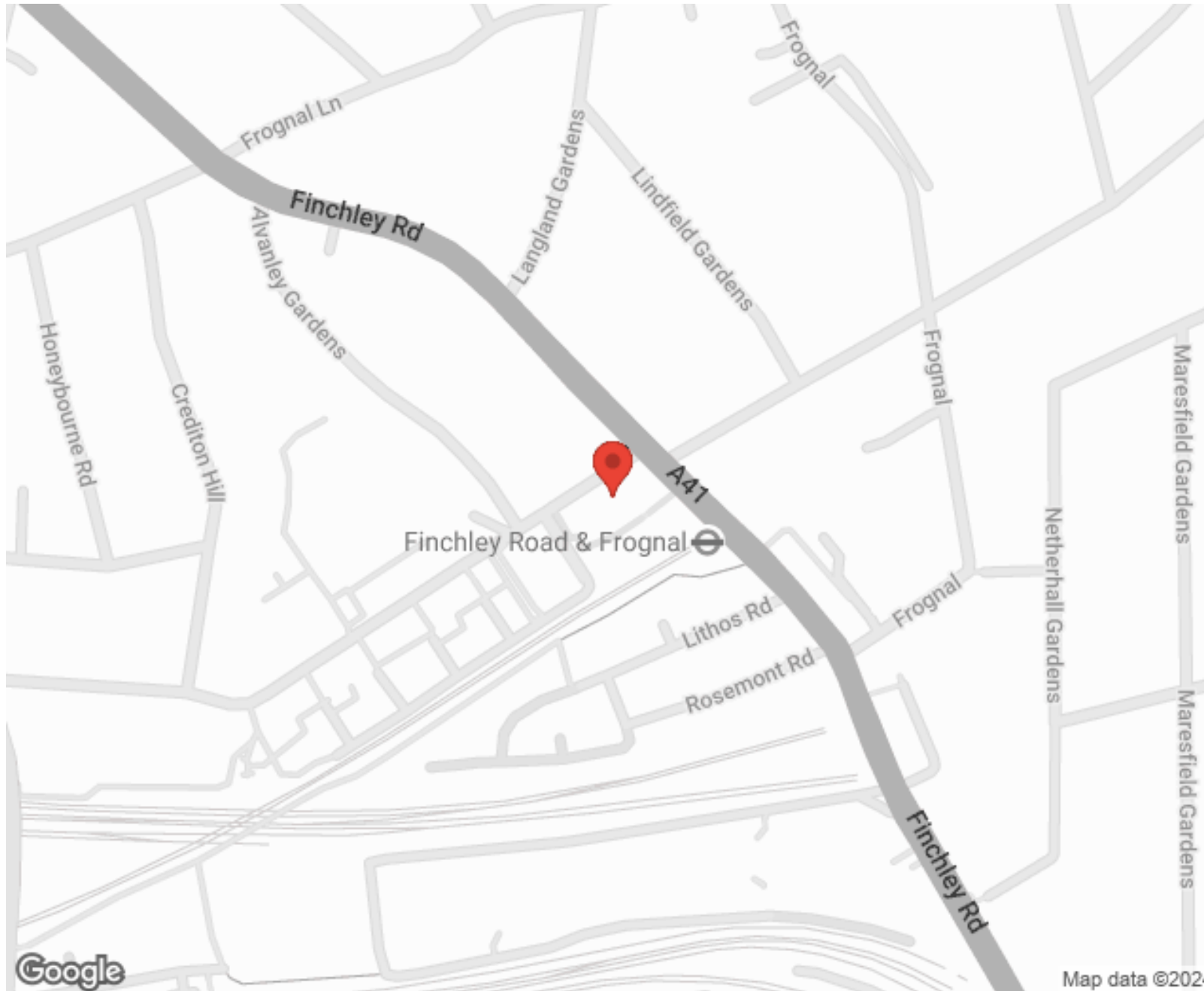

SCAN FOR MORE  
GOOGLE REVIEWS





Google



4.9 Stars | 132 Reviews

Find us on social media

-  vitaproperties
-  VitaProperties
-  VitaProperties

LYMINGTON ROAD, NW6  
TOTAL APPROX. FLOOR AREA 800 SQ.FT. (74.3 SQ.M.)

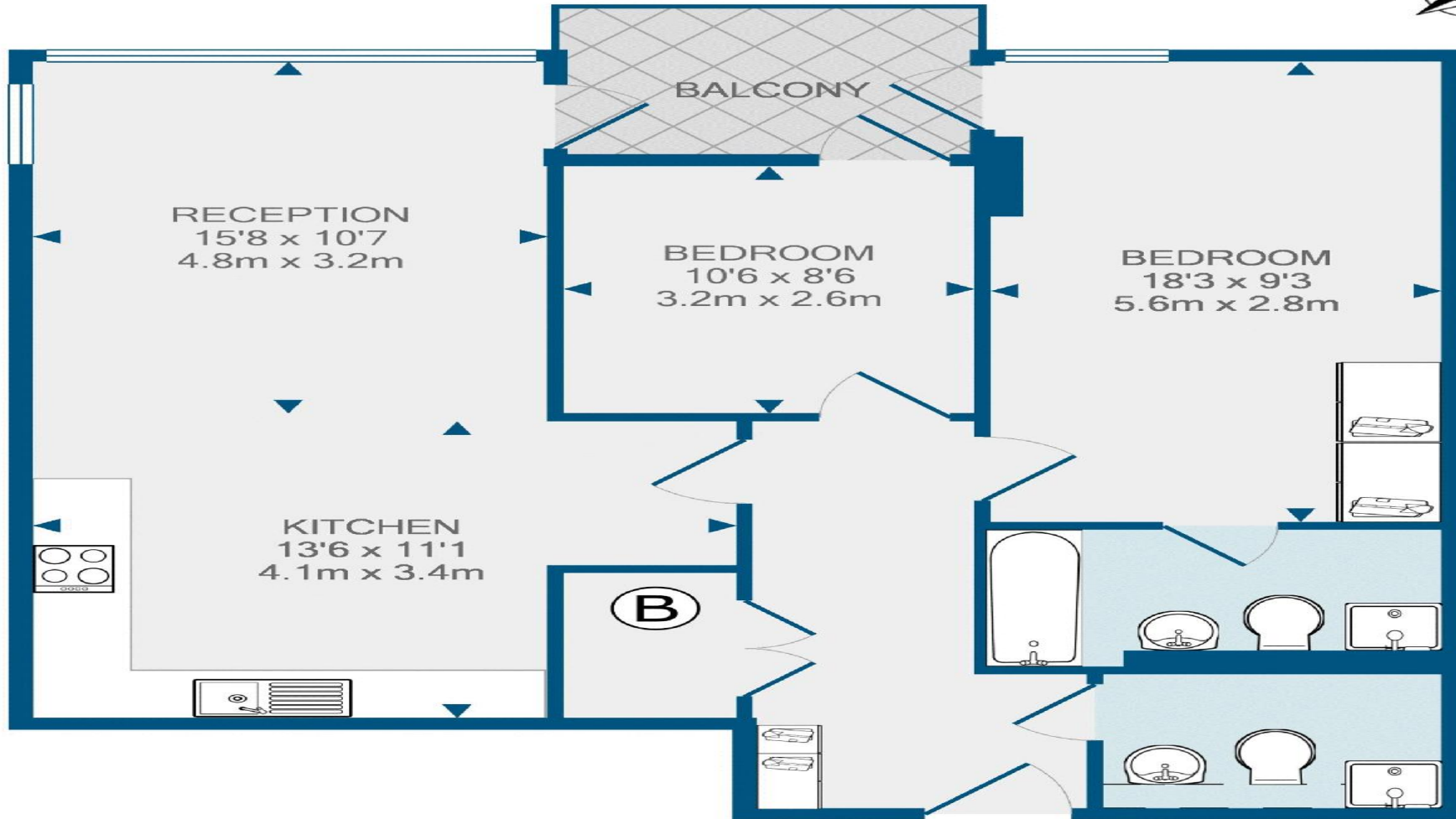

FOURTH FLOOR