



Fitzjohns Avenue, Hampstead, London, NW3 .| £495

- 2 very large double bedrooms
- Open plan kitchen/reception
- Wooden floors and brand new carpet in the bedrooms
- Available 21 November

- Unfurnished
- Council tax - E - £1614 per annum

"Vita Properties have been tremendously helpful throughout the process of securing/renting my flat. Informative about the property, prompt communication, easy to use dashboard for sharing of information, and pleasant to work with. Highly recommend!"

This spacious two double bedroom apartment set on the first floor of a period conversion located on a tree-lined street within 500m to both Finchley Road & Swiss Cottage stations.

The property has a modern finish and enjoys an open plan kitchen/reception with bay window, two equal sized bedrooms, a tiled bathroom.

The flat further benefits from being only minutes away from Hampstead and Belsize Village



Oliver Kent

✉ [oliver.kent@vitaproperties.uk](mailto:oliver.kent@vitaproperties.uk)  
☎ +4477 7274 0351



🏠	Flat
🔑	Available to Let
🛏️	x 2
🛋️	x 1
🚿	x 1



"I was very impressed with Vita and their network of buyers. When the sale of my flat fell through (twice) they worked extremely hard to find new buyers in a difficult market - thank you!"

---



"Working with Vita properties has been a smooth experience! No complaints at all. Our letting agent, Diana has been fantastic and very helpful throughout the whole process. I would highly recommend both Vita properties and Diana."

---





"I used Vita properties to find a flat recently and it was an overall professional, personalised and positive experience. Saira went the extra mile to accommodate to our needs and quick to help us whenever possible."

---



**MORE INFO, PICTURES,  
CONTACT ON  
OUR WEBSITE**



"Vita Properties is a very professional agency. My experience with them was incredible and the entire team was very helpful and kind throughout the renting process. I'd highly recommend!"

---

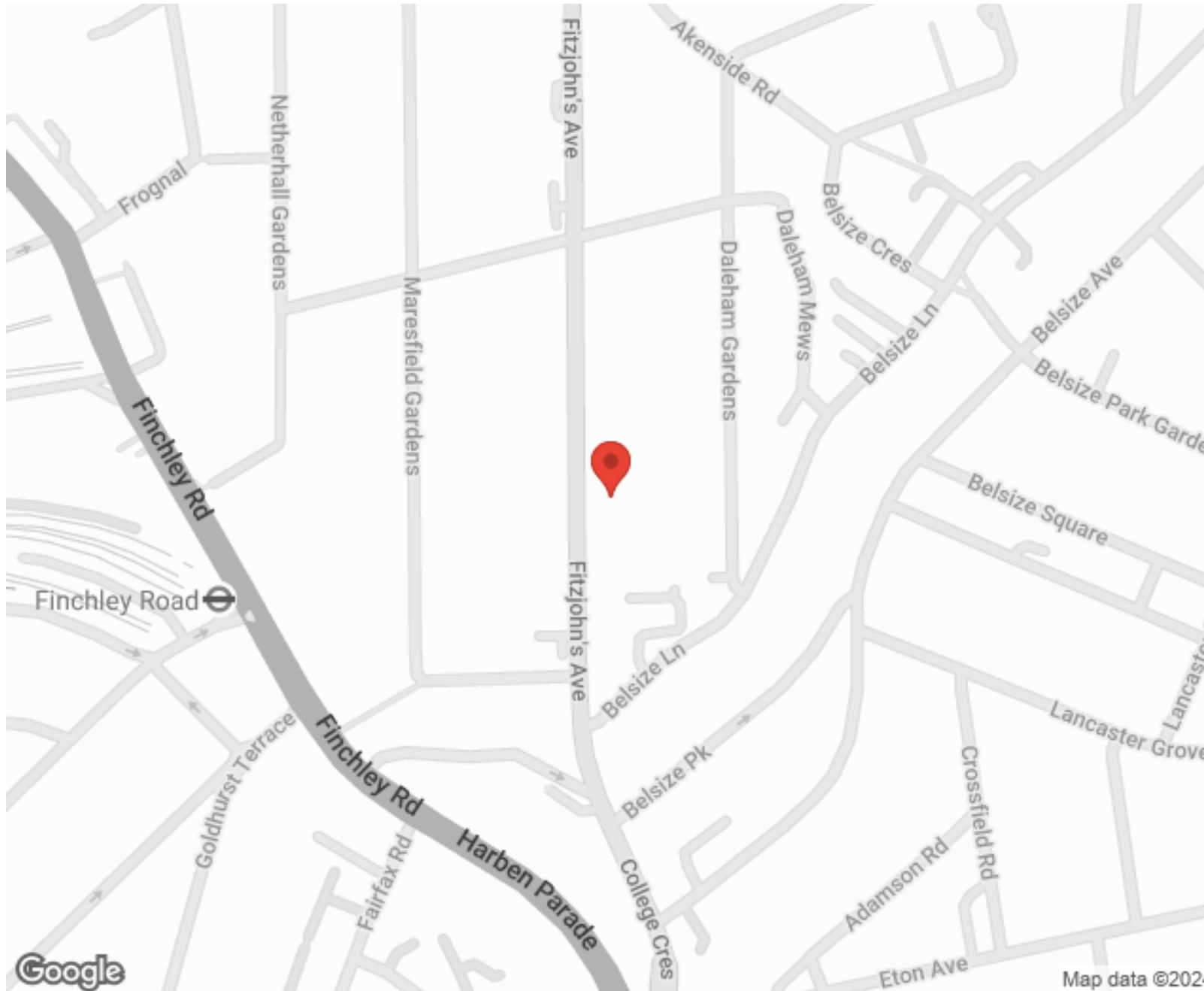

SCAN FOR MORE  
GOOGLE REVIEWS



Google



4.9 Stars | 132 Reviews

Find us on social media

 vitaproperties

 VitaProperties

 VitaProperties

Fitzjohns Avenue

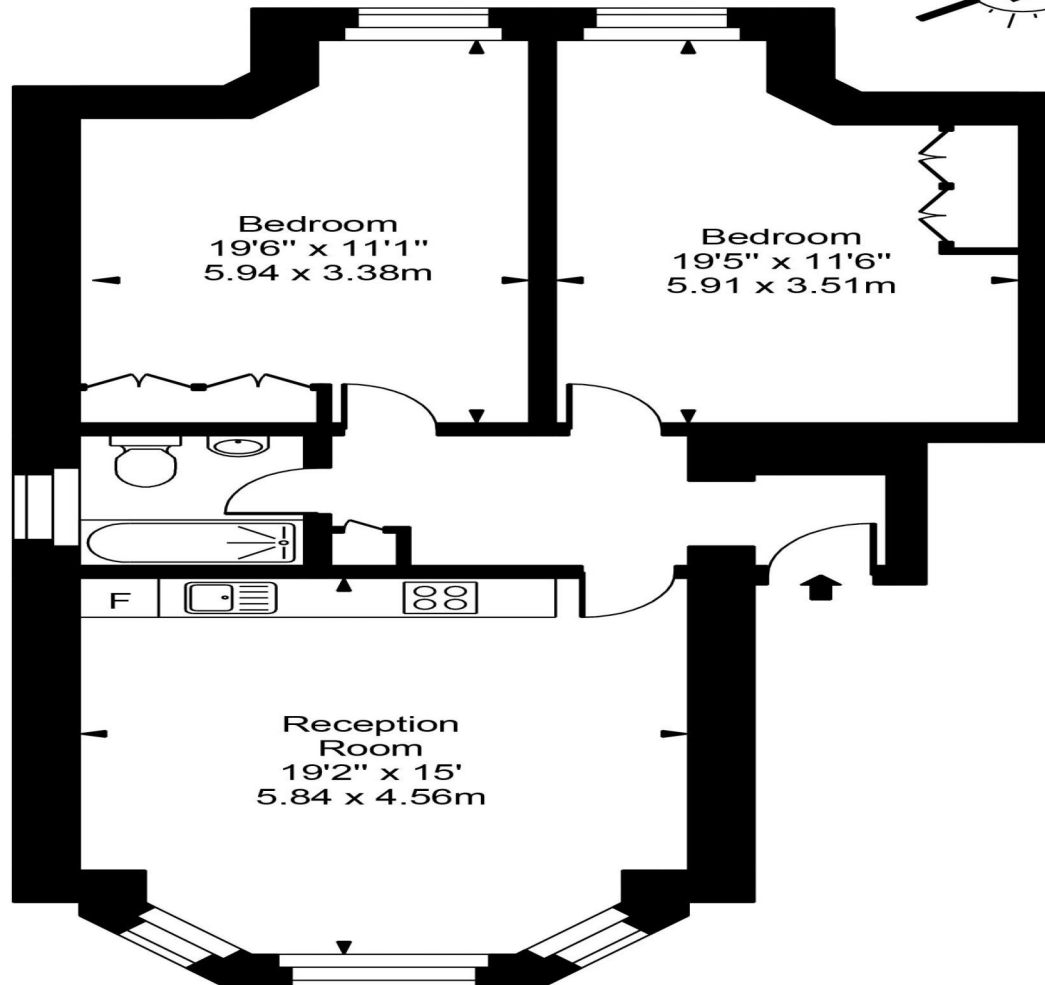

First Floor

Approx Gross Internal Area      824 Sq Ft - 76.55 Sq M

For Illustration Purposes Only - Not To Scale  
Floor plan by [www.creativeplanetlk.com](http://www.creativeplanetlk.com)

