



Arkwright Road, Hampstead , London, NW3 .| £6,000

- 
- 3 Large Double Bedrooms
  - 3 Bathrooms
  - Early Viewings Recommended
  - Council tax - F - £1908 per annum

"Vita Properties have been tremendously helpful throughout the process of securing/renting my flat. Informative about the property, prompt communication, easy to use dashboard for sharing of information, and pleasant to work with. Highly recommend!"

---

We are excited to bring to the market this fully extended 3 bedroom, 3 bathroom apartment set within moments of Hampstead Village. Being totally renovated this modern apartment has been interior designed and offers 3 large double bedrooms, 2 fully tiled ensuite's and a guest bathroom, wooden floors, a stunning large reception room with retracting doors opening on to a decked terrace and leading down to a private lawned garden, a fully fitted open plan kitchen, guest wc with utility area and 1 allocated off street parking space.

Arkwright Road is located just off Finchley Road and Fitzjohns Avenue offering easy access to all the surrounding areas including the northern line and Finchley's road overland, Jubilee and Metropolitan train lines, it is also within close proximity to the M1 and the centre of London.

🏠 Flat  
🔑 Available  
to Let  
🛏 x 3  
🛏 x 1  
🚿 x 3



Oliver Kent

✉️ [oliver.kent@vitaproperties.uk](mailto:oliver.kent@vitaproperties.uk)  
☎️ +4477 7274 0351





"I was very impressed with Vita and their network of buyers. When the sale of my flat fell through (twice) they worked extremely hard to find new buyers in a difficult market - thank you!"

---



"Working with Vita properties has been a smooth experience! No complaints at all. Our letting agent, Diana has been fantastic and very helpful throughout the whole process. I would highly recommend both Vita properties and Diana."

---





"I used Vita properties to find a flat recently and it was an overall professional, personalised and positive experience. Saira went the extra mile to accommodate to our needs and quick to help us whenever possible."

---



MORE INFO, PICTURES,  
CONTACT ON  
OUR WEBSITE



"Vita Properties is a very professional agency. My experience with them was incredible and the entire team was very helpful and kind throughout the renting process. I'd highly recommend!"

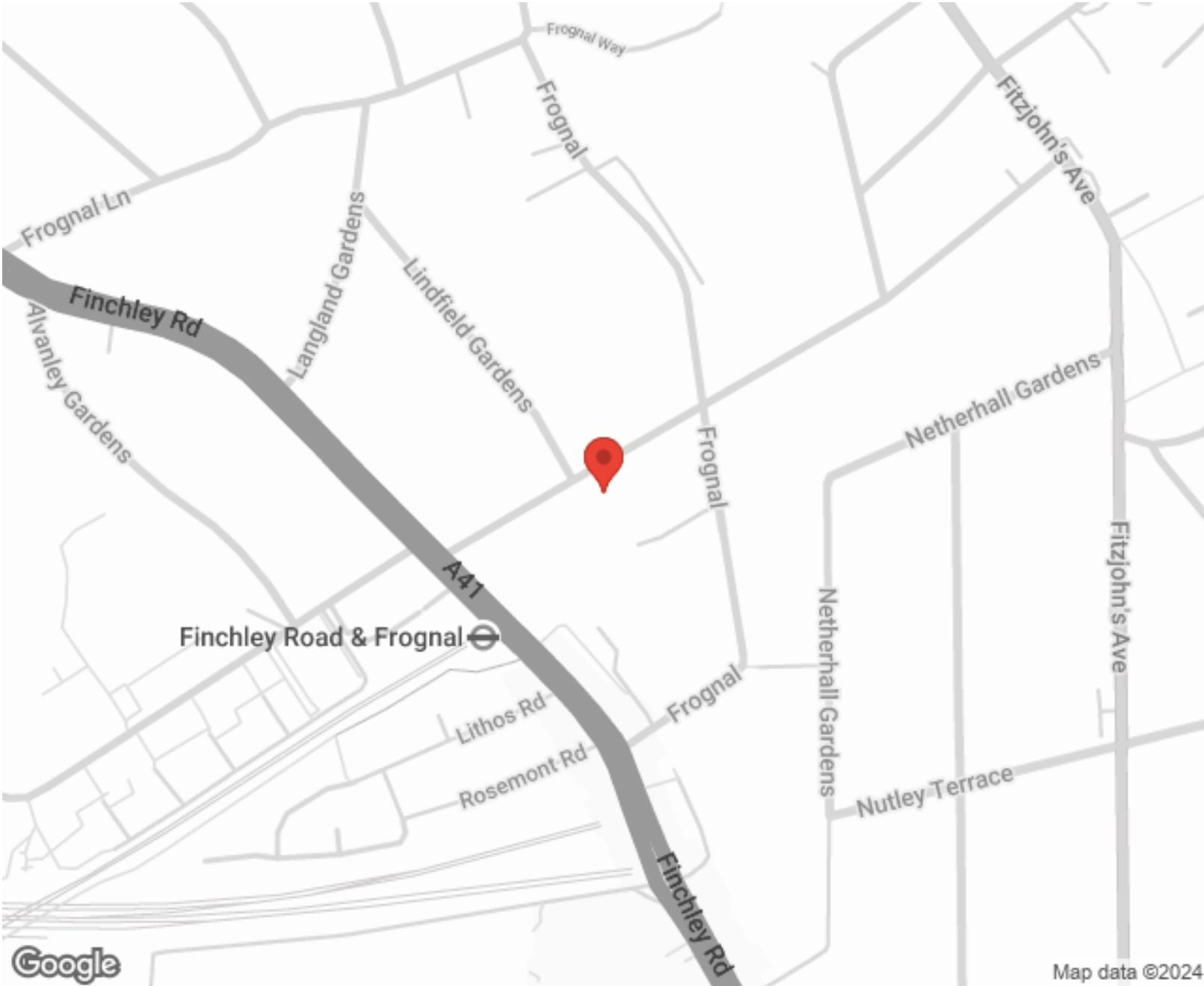

Energy Efficiency Rating		Environmental Impact (CO <sub>2</sub> ) Rating			
	Current	Potential		Current	Potential
Very energy efficient - lower running costs					
(92-100) A			Very environmentally friendly - lower CO <sub>2</sub> emissions		
(81-91) B			(92-100) A		
(69-80) C			(81-91) B		
(55-68) D			(69-80) C		75
(39-54) E			(55-68) D		57
(21-38) F			(39-54) E		
(1-20) G			(21-38) F		
Not energy efficient - higher running costs					
Not environmentally friendly - higher CO <sub>2</sub> emissions					
England, Scotland & Wales		EU Directive	England, Scotland & Wales		
					

SCAN FOR MORE  
GOOGLE REVIEWS

Google  
★★★★★  
4.9 Stars | 132 Reviews

Find us on social media

vitaproperties

VitaProperties

VitaProperties

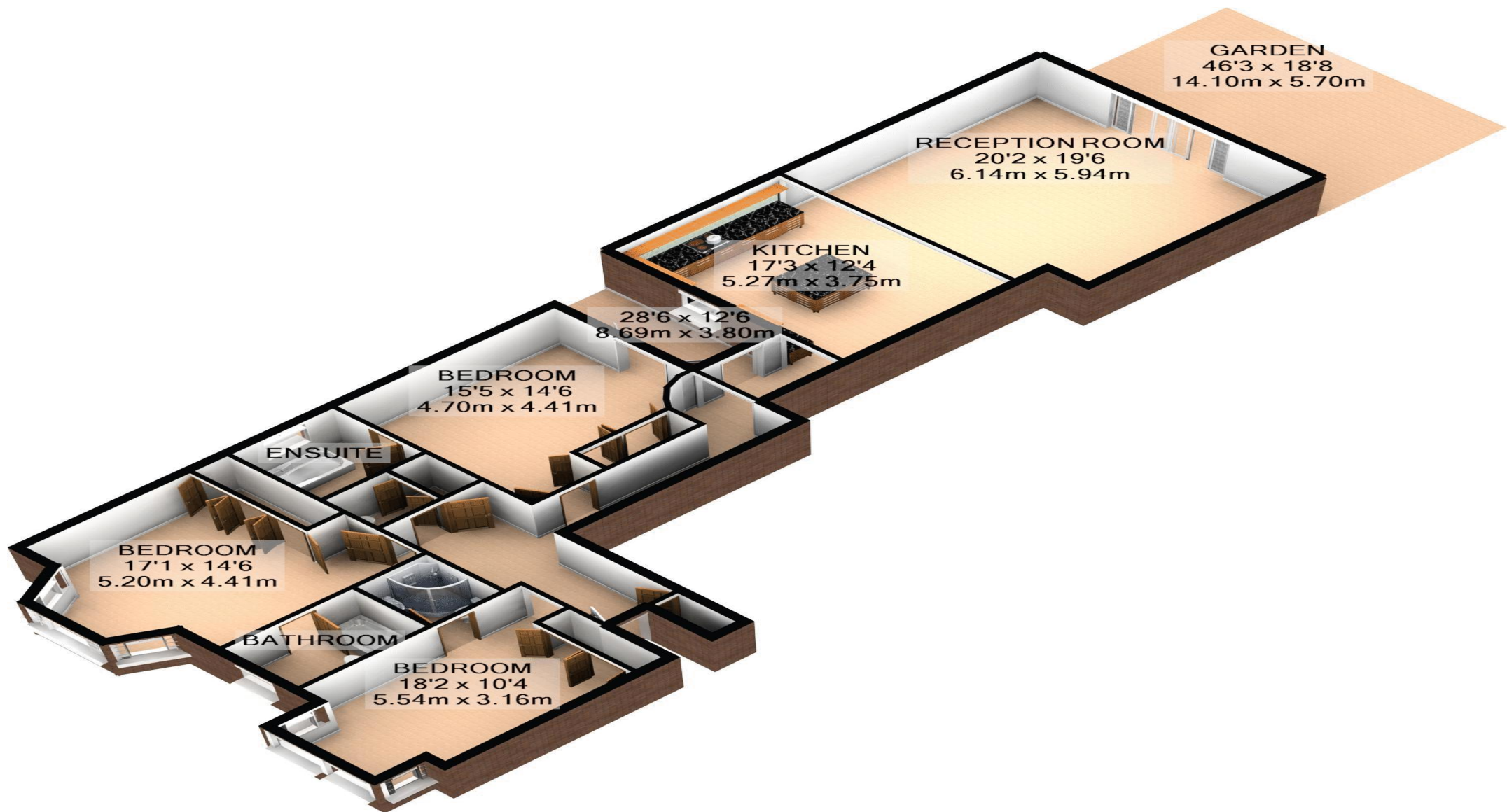

**Total Approx. Floor Area 1557 Sq.Ft. (144.6 Sq.M.)**

KeyAGENT LTD Floor Plans are produced and provided for illustration purposes only. Whilst every attempt has been made to ensure the plan is accurate and presents the property in the best way, measurements of doors, windows and rooms are approximate and no responsibility is taken for any error, omission or mis-statement. To find out more about KeyAGENT please visit [www.keyagent.co.uk](http://www.keyagent.co.uk)  
(Tel: 0845 475 4165)  
Made with Metropix ©2012