



## Belsize Park, Swiss Cottage, London, NW3 .| £575

- High ceilings
- Contemporary kitchen and bathroom
- Newly refurbished 1st floor apartment
- Close to the Jubilee line (approx: 0.3 miles)
- Council tax - F - £1914 per annum
- Available 24 March 2016 - Unfurnished

"Vita Properties have been tremendously helpful throughout the process of securing/renting my flat. Informative about the property, prompt communication, easy to use dashboard for sharing of information, and pleasant to work with. Highly recommend!"

Available 24 March 2016 is this brand newly refurbished 2 bedroom apartment situated in a fantastic location close to Belsize Park and Finchley Road. Set in a beautiful period conversion the property boasts a separate modern kitchen and two bathrooms (one en suite). Further benefits include ample storage space, floor to ceiling windows, fitted wardrobes in both bedrooms, high ceilings with a bright and airy feel throughout. Belsize Park is a popular residential road close to the local amenities of Belsize Village and nearby shops of Finchley road. Also set within close proximity to Swiss Cottage (Jubilee) Underground and South Hampstead Rail Links. Offered Unfurnished.



Oliver Kent

✉ [oliver.kent@vitaproperties.uk](mailto:oliver.kent@vitaproperties.uk)

☎ +4477 7274 0351



🏠	Flat
🔑	Available to Let
🛏	x 2
🛋	x 1
🚿	x 2



"I was very impressed with Vita and their network of buyers. When the sale of my flat fell through (twice) they worked extremely hard to find new buyers in a difficult market - thank you!"

---



"Working with Vita properties has been a smooth experience! No complaints at all. Our letting agent, Diana has been fantastic and very helpful throughout the whole process. I would highly recommend both Vita properties and Diana."

---



"I used Vita properties to find a flat recently and it was an overall professional, personalised and positive experience. Saira went the extra mile to accommodate to our needs and quick to help us whenever possible."

---



**MORE INFO, PICTURES,  
CONTACT ON  
OUR WEBSITE**



"Vita Properties is a very professional agency. My experience with them was incredible and the entire team was very helpful and kind throughout the renting process. I'd highly recommend!"

---

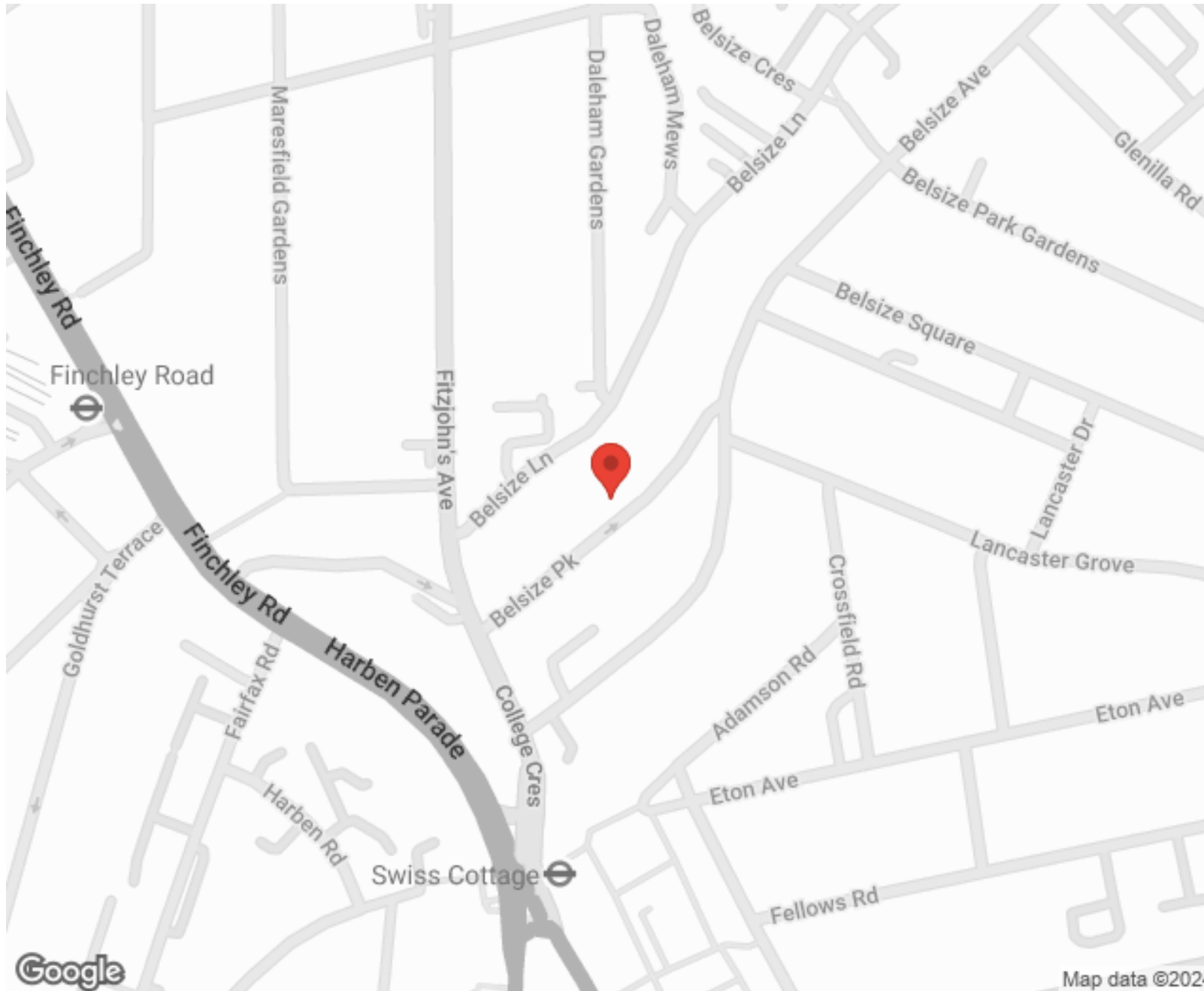

SCAN FOR MORE  
GOOGLE REVIEWS





Google



4.9 Stars | 132 Reviews

Find us on social media

-  vitaproperties
-  VitaProperties
-  VitaProperties

Google

Map data ©2024

# Belsize Park

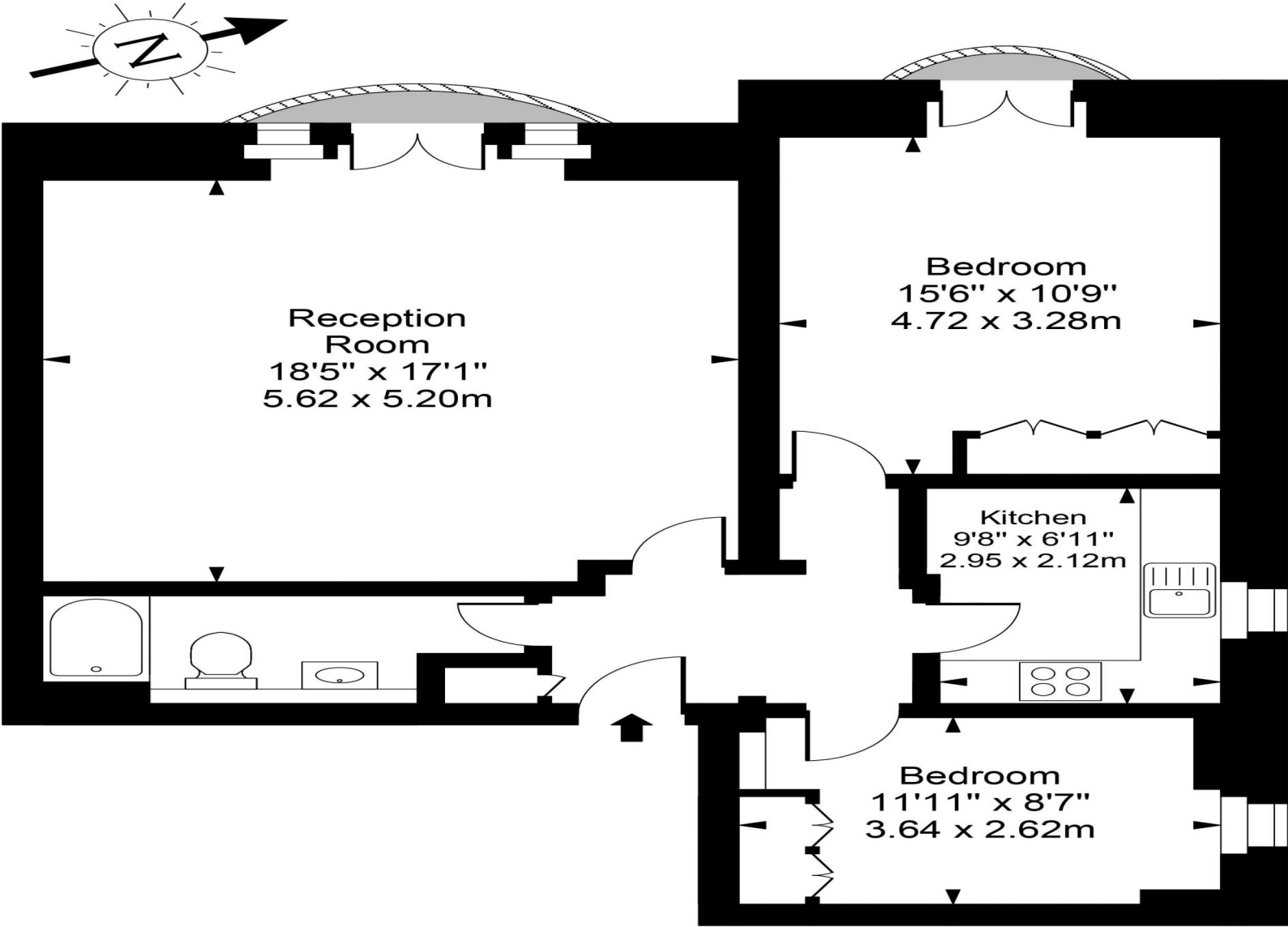

First Floor



Approx Gross Internal Area **839 Sq Ft - 77.95 Sq M**

For Illustration Purposes Only - Not To Scale  
Floor plan by [www.creativeplanetlk.com](http://www.creativeplanetlk.com)